

SoftBank 103P

User Guide



SoftBank

Introduction

Thank you for purchasing SoftBank 103P.

- Read this guide thoroughly beforehand for proper usage.
- Accessible services may vary by service area, subscription, etc.

SoftBank 103P is compatible with both 3G and GSM network technologies.

Note

- Unauthorized copying of any part of this guide is prohibited.
- Guide content is subject to change without prior notice.
- Efforts have been made to ensure the accuracy and clarity of this guide. Please contact SoftBank Customer Support, General Information (📞 P.9-21) about unclear or missing information.

Contents

Getting Started

Package Contents	1-1
Using This Guide	1-1
USIM Card Installation	1-3
Charging Battery	1-4
microSD Card Installation	1-5
Parts & Functions	1-6
Basic Operations	1-8
Display	1-10
Handset Menus	1-11
Handset Security	1-13
Mobile Manners	1-14

Text Entry

Entering Text	2-1
Editing Text	2-4

Calling

Emergency Calls	3-1
Voice Calls	3-1
Video Calls	3-2
International Calls	3-3
Answer Phone	3-5
Optional Services	3-6
Phone Book	3-9

Messaging

Basics	4-1
Customizing Handset Address	4-2
Sending S! Mail & SMS	4-3
Receiving Messages	4-4
PC Mail	4-6

Internet

Getting Started	5-1
Accessing Internet	5-2
Bookmarks & Saved Pages	5-3
Internet Settings	5-4

Connectivity

Infrared	6-1
Bluetooth®	6-3
External Devices	6-5

Camera

Before Using Camera	7-1
Taking Photos	7-4
Recording Videos	7-4
Camera Functions	7-5

Other Functions

Digital TV	8-1
Media Player	8-4

Appendix

Handset Data Backup	9-1
Software Update	9-2
Troubleshooting	9-3
Safety Precautions	9-5
Handling Precautions	9-12
Copyrights	9-16
RF Exposure Information/ Specific Absorption Rate (SAR) Information	9-19
Specifications	9-20
Support	9-20

Getting Started

Package Contents

□ Handset (103P)

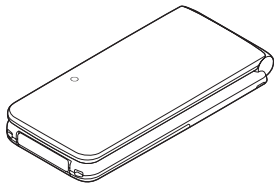

□ Battery (PMBAS1)

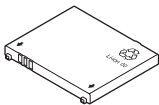

□ クイックスタート (Japanese)

□ お取り扱いとご注意 (Japanese)

□ 保証書 (Japanese)

Note

- Use SoftBank Mobile specified AC Charger (sold separately) to charge Battery.
- For more information about AC Charger and accessories, please contact SoftBank Customer Support, General Information (☎ P.9-21).
- 103P accepts microSD or microSDHC Card (not included). Purchase one to use related functions (☎ P.1-5, P.9-1).

Using This Guide

Before reading on, please make note of the following:

- SoftBank 103P is referred to as "handset" or "103P."
- "microSD Card" and "microSDHC Card" are referred to as "microSD Card."
- Screenshots, etc. are for reference. Actual handset windows, menus, etc. may differ.
- Key icons are simplified.
- Most operation descriptions begin in Standby.
- Pressing a Key for more than one second is described as "Press and Hold."

Guide Symbols

Softkeys

Press the corresponding Key to execute the function or operation indicated at the bottom of Display.

Example:

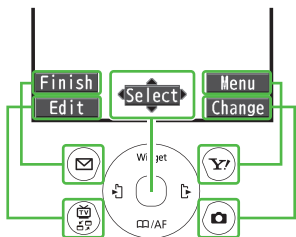

Multi Selector

Use Multi Selector to select items, navigate menus, etc. In this guide, Multi Selector operations are indicated as shown below.

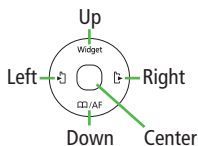

Up	Up/Down	Up/Down/Left/Right
Down		
Left	Left/Right	Center
Right		

Japanese Functions & Services

When "(Japanese)" appears in a title, Japanese ability is required to use full range of the function or service.

USIM Card Installation

- Always power off handset before removing Battery.
- USIM PINs:  P.1-13

Inserting

- 1 With IC chip down, insert USIM Card

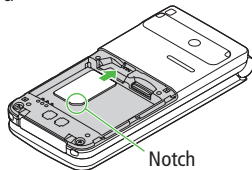

Removing

- 1 Slide out USIM Card gently

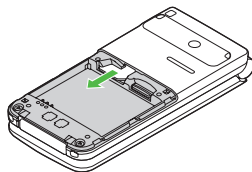

Important

- USIM Card is the property of SoftBank Mobile.
- Return USIM Card to SoftBank Mobile upon service cancellation.
- USIM Card will be reissued for a fee if lost or damaged.
- If USIM Card/handset with USIM Card installed is lost or stolen, contact SoftBank Customer Support or SoftBank Mobile Global Call Center ( P.9-21).
- Back up USIM Card files. SoftBank Mobile is not liable for lost files.
- USIM Card specifications/performance may change without prior notice.
- Pre-installed S! Appli may be unusable while a different or replacement USIM Card is installed.
- Some downloaded files may be inaccessible after upgrades/repairs, USIM Card/handset replacement.
- Returned USIM Cards are recycled.

Note

- Do not forcefully insert/remove USIM Card; may damage handset/USIM Card.
- Avoid touching USIM Card terminals or IC chip. Doing so may hinder performance/USIM Card recognition.

Charging Battery

Battery Installation

- Always power off handset before removing Battery.

1 Press and slide to remove Battery Cover

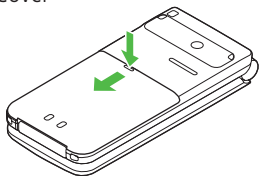

2 Insert Battery

Align Battery contacts with handset pins

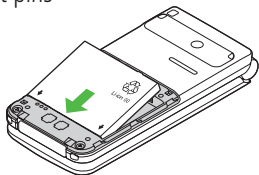

Remove Battery

Lift Battery out

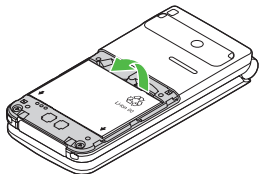

3 Replace Battery Cover

Battery Cover should click into place.

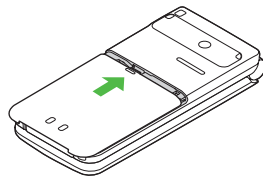

Note

- Lithium-ion batteries are valuable and recyclable resources.
 - Recycle used lithium-ion battery at shops displaying this symbol:
 - To avoid fire or electric shock, do not:
 - Short-circuit Battery
 - Disassemble Battery



Li-ion 00

Charging Battery

- Use only specified AC Charger (sold separately).

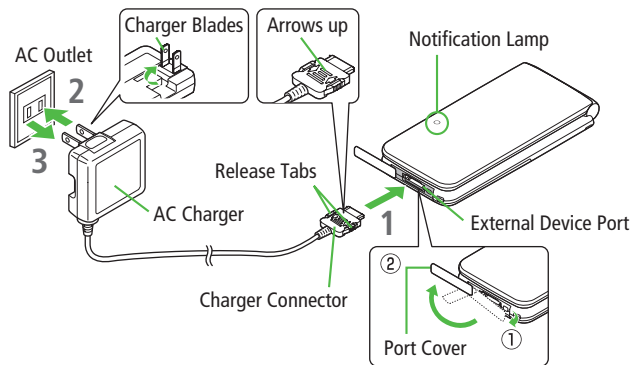

- 1 Connect AC Charger to handset
- 2 Extend Charger blades, and plug AC Charger into AC outlet
Notification Lamp illuminates and charging starts.
When charging is complete, Notification Lamp goes out.
- 3 When charging is complete, unplug AC Charger, then disconnect handset
Squeeze release tabs to remove Charger connector, and replace Port Cover.

microSD Card Installation

- Always power off handset before removing Battery.
- Handset Data Backup: ➔ P.9-1

Inserting

- 1 Insert microSD Card until it clicks

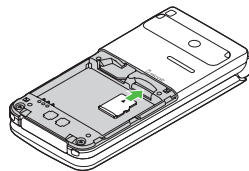

Format microSD Card

> **Main Menu** > **Tools** > **microSD Backup** > **Refer Data** > [Y] **[Menu]**
> **microSD format** > Enter Phone Password > **YES**

- Formatting microSD Card deletes all saved files/data.
- Do not power off handset or remove microSD Card while formatting; may damage handset or microSD Card.

Removing

- 1 Push microSD Card in
 - microSD Card pops out with a light push.

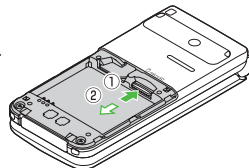

Parts & Functions

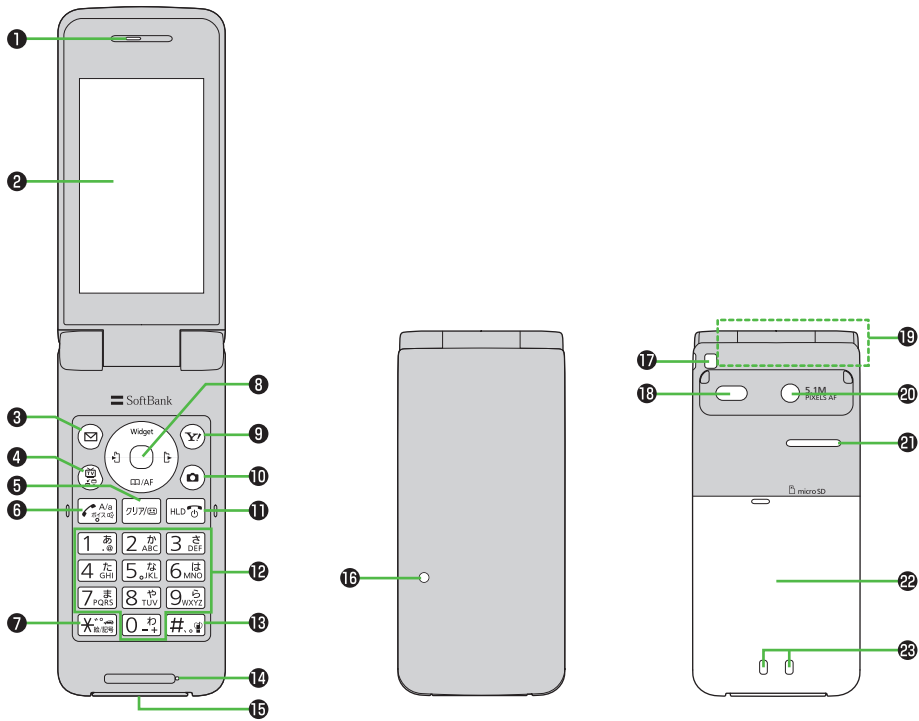

Getting Started

- 1 **Earpiece**
- 2 **Display**
- 3  **Mail Key**
 - Open Messaging menu
 - Execute Upper Left Softkey function
- 4  **TV Key**
 - Activate TV
 - Open TASK MENU
 - Execute Lower Left Softkey function
- 5  **Clear/Memo Key**
 - Delete characters
 - Cancel menus
 - Use Answer Phone
- 6  **Send Key**
 - Initiate or answer calls
 - Toggle upper/lower case in text entry windows
 - Use Voice Dial
- 7  *** /Pictograph/Symbol/Driving Mode Key**
 - Enter " * "
 - Access pictographs in text entry windows
 - Toggle Driving Mode on/off
- 8  **Multi Selector**
 - Move cursor or select menus (➡ P.1-2)
 -  Select icons/S! Quick News
 -  Open Phone Book
 -  Open Received call logs
 -  Open Redial logs
- 9  **Yahoo! Keitai Key**
 - Open Yahoo! Keitai top menu
 - Execute Upper Right Softkey function
- 10  **Camera Key**
 - Activate Camera
 - Execute Lower Right Softkey function
- 11  **End/Escape & Power Key**
 - Power on/off (➡ P.1-8)
 - End calls
 - Return to Standby
- 12  -  **Numeric Keys**
 - Enter phone number/text
- 13  **# /Manner Mode Key**
 - Enter " # "
 - Toggle Manner Mode on/off
- 14 **Mic**
- 15 **External Device Port**
 - Connect AC Charger, earphone or other accessories here
- 16 **Notification Lamp**
 - Flashes for incoming transmissions
 - Lights for charging
- 17 **Strap Eyelet**
- 18 **Infrared Port**
 - Transfer data via Infrared
- 19 **Internal Antenna Area**

- 20 **Camera**
- 21 **Speaker**
- 22 **Battery Cover**
- 23 **Charging Terminals**

Note

- Do not press microphone button when connecting Earphone with Mic. Doing so may cause malfunction. If pressed accidentally, unplug then reconnect it.

Basic Operations

Power On/Off

1 Power On

Press and Hold 

Start-up window appears and handset enters Standby.



Power Off

Press  for 2+ seconds → **YES**

Handset shuts down.





Initial Setup

The first time handset powers on and Initial setting window appears, select **YES** and set the following: (Each item can be set separately.)

Date & Time*  P.1-9	Set date and time
Phone Password  P.1-13	Enter 9999 , and enter new Phone Password
Key Tone	Select ON or OFF
Font Size	Set Display font size all at once

*May set/adjust automatically upon network connection.

Retrieving Network Information

Pressing , ,  or  for the first time in Standby may initiate Network Information retrieval. Press  to retrieve it.

- Update Network Information to use messaging, Internet, etc.
- Update Network Information manually: **Main Menu ► Settings ► Connectivity ► Retrieve NW Info ► YES**

Keyguard

Lock handset Keys to prevent accidental operation.

- While set,  appears in Standby.

1 Press and Hold

- To cancel Keyguard, repeat operation.

While Keyguard is Active

- Answer incoming calls by Pressing .
- Once emergency numbers (110, 119, 118) are dialed, Keyguard is canceled.

English Interface

Main Menu ► 設定 ► ディスプレイ設定 ► Language ► English

Date & Time

Main Menu ► Settings ► Date & Time

1 *Date & Time*

2 Enter year → Enter date → Enter time

■ World Clock

> After Step 2, highlight time zone → [Edit] → [Select] to select a time zone

- Alternatively, in Step 1, **World Clock** → **ON** → [Select] to select an area → [Select].

My Number

1 [Select] → [0]

■ Edit Account Details

Save phone number, mail address, street address, etc. in Account Details.

- Handset phone number cannot be edited or deleted.

> After Step 1, [Edit] → Enter Phone Password → Edit → [Finish]

■ Send Account Details via Infrared

> After Step 1, [Ir]

Display

Icons & Indicators



1 Display Indicators

Signal Strength

Strong Moderate Weak Low

Offline Mode Active

OUT Out-of-Range

Battery Level

→ → → (Red)

Data Transmission

3G/GSM Packet Transmitting

Network Service

Operator (set for Select Operator)
Out-of-Range

/ 3G/GSM Packet Transmission Available*

/ 3G/GSM Packet Transmission
Unavailable*

* Appears only while abroad

Secure Content

PC Site Browser Active

Infrared Active

USB Cable Connected

Keyguard Active

Voicemail

(Blue) Bluetooth® Device Connected

microSD Card Installed

Unread Message

Unread Urgent News

Manner Mode Active

Software Update
(Notification/Updating/Result)

Digital TV Active

Timer Recording in Progress

Recording TV Program/Paused

Music Playback/Paused

Vibration Active (Incoming Call/Message)

Incoming Call/Message Ringtone Disabled

Driving Mode Active

USB Mode

Communication Mode

microSD Mode

Answer Phone Active (Number of Recorded Messages (Voice Call))

Answer Phone Active (Number of Recorded Messages (Video Call))

2 Information Window (P.1-11)

Information Window

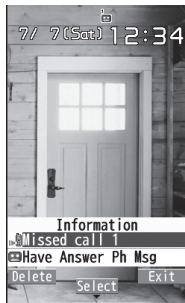

In Standby, Information Window opens for missed events.
Select a notification to view/access information.

- 1 Highlight an item → 
Follow onscreen instructions.

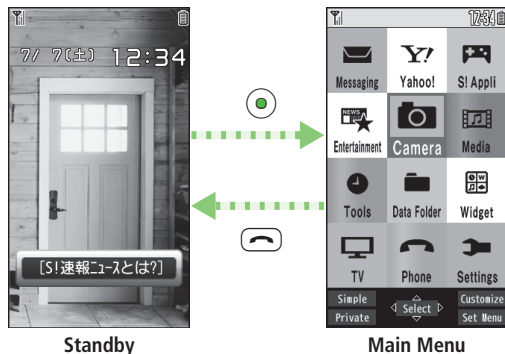

Handset Menus



- 1 In Standby, 
Main Menu appears.
- 2  to highlight an icon →  [Select]
Selected function menu appears.
 - To return to Standby: 

Function List

Messaging

Incoming Mail
Create New
Retrieve New
Drafts
Templates
Sent/Unsent
Server Mail
Create New PC Mail
Create New SMS
Settings
Memory Status

Yahoo!

Yahoo! Keitai
Menu List
Bookmarks
Saved Pages
Web Search
Enter URL
History
PC Site Browser
Set Yahoo! Keitai
Reset

S! Appli

S! Appli List
S! Appli Settings
S! Appli History
Information

Entertainment

S! Info Ch./Weather
S! Quick News
Free Contents
S! Contents Store
Post Blog

Camera

Camera
Video Camera

Media

Music
Videos

Tools

Alarms
Calendar
Calculator
Notepad
Tasks
Sound Recorders

Barcode Reader
Location Settings
Bluetooth
Receive via Infrared
Music Player
microSD Backup
Templates/User Dic.

Data Folder

Pictures
Ring Songs&Tones
S! Appli
Widget
Music
Videos
TV
Books
Customized Screen
Templates
Font
Other Documents

Widget

Widget Store
Widget Contents
Settings

TV

Watch TV
Program List
Timer Watching
Timer Recording
Recording Result
TV Link
Channel List
Channel Setting
User Settings

Phone

Phone Book
Create New Entry
Call Log
Account Details
S! Addressbook BkUp
Group
Memory Manager
Restrictions
Settings
Memory Status

Settings

Sound Settings
Display Settings
Customized Screen
Incoming Settings
Phone Settings
Date & Time
Security
Call Settings
Video Call
International Call
Connectivity
Notification Light

Handset Security

USIM PINs

PIN	4 to 8-digit code used to prevent unauthorized handset use. <ul style="list-style-type: none">When PIN Authentication is ON, PIN entry is required each time handset is powered on (with USIM Card installed).
PIN2	Required for call cost setting.

- PIN and PIN2 are set to **9999** by default.

PIN Authentication

Main Menu ► **Settings** ► **Security** ► **PIN Authentication**

- Enter Phone Password → **PIN Authentication** → **ON** or **OFF** → Enter PIN

PIN/PIN2 Lock & Cancellation (PUK/PUK2)

PIN Lock or PIN2 Lock is activated if PIN or PIN2 is incorrectly entered three times. Cancel PIN Lock or PIN2 Lock by entering PIN Unblocking Key (PUK/PUK2).

- For information about PUK/PUK2, contact SoftBank Customer Support, General Information (☎ P.9-21).

Note

- If PUK/PUK2 is incorrectly entered ten times, USIM Card is locked and handset is disabled. Write down PUK/PUK2.
- For USIM Card recovery, contact SoftBank Customer Support, General Information (☎ P.9-21).

Passwords

The following passwords are required for handset use.

Phone Password	4 to 8-digit number required to use/change some handset functions. (9999 by default.)
Center Access Code (Security Code)	4-digit number specified at initial subscription; required to access optional services via landlines, set Call Restrictions, subscribe to paid content.

- Enter number within 15 seconds. _ appears for each digit entered.
- Do not forget Phone Password/Center Access Code (Security Code). For password recovery, contact SoftBank Customer Support, General Information (☎ P.9-21).
- Do not reveal Phone Password/Center Access Code (Security Code). SoftBank Mobile is not liable for misuse or damages.

Note

- If entered incorrectly, an error message appears. Reenter the password.
- If Center Access Code (Security Code) is entered incorrectly three times, Call Barring settings lock; Center Access Code (Security Code) must be changed. For details, contact SoftBank Customer Support, General Information (☎ P.9-21).
- If Security Code has been changed on handset, enter the number to activate/cancel Call Barring.

Change Phone Password

> **Main Menu** ► **Settings** ► **Security** ► **Change Phone Password** ►

Enter current Phone Password ► Enter new Phone Password ► **YES**

Mobile Manners

Minding Mobile Manners



Please use your handset responsibly. Inappropriate handset use can be both dangerous and bothersome.

- Power off handset in theaters, museums and other places where silence is the norm.
- Refrain from use in restaurants, lobbies, elevators, etc.
- Observe signs and instructions regarding handset use aboard trains, etc.
- Refrain from use that interrupts the flow of pedestrian or vehicle traffic.

Manner-related Features

Manner Mode	Mute handset tones and activate Vibration for incoming transmissions.
Vibration	Activate in public places, meetings, etc. for silent call/message alerts.
Ringer Volume	Adjust call/message tones, etc.
Offline Mode	Suspend all handset transmissions.
Answer Phone	Use to handle incoming calls when inappropriate/unsafe to answer.
Driving Mode	While driving, send a voice message informing the caller that you cannot answer the call. (Handset does not ring.)

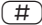
Manner Mode



- 1 In Standby, Press and Hold 
 appears.
 - To cancel: Press and Hold  again

Offline Mode

Main Menu ► Settings ► Call Settings ► Offline Mode

- 1 YES
 appears.
 - To cancel: Follow the same steps

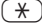
Driving Mode

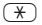
- 1 In Standby, Press and Hold 
 appears.
 - To cancel: Press and Hold  again

Text Entry

Entering Text

Enter alphanumerics, hiragana, kanji, katakana, symbols and pictographs.

- There are two character input methods: 5-touch and 2-touch
In this guide, examples are described for 5-touch.

2-touch

Press two Numeric Keys to enter a character.

■ Text Entry Window

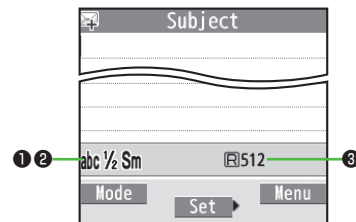

① Character Input Methods		Operations
5-touch/2-touch		Press and Hold [Mode]
② Input Modes (Double-byte/Single-byte)		Operations
5-touch	漢 ¹ / ₁ : Kanji (hiragana) (double-byte) か ¹ / ₁ / 加 ¹ / ₂ : Katakana abc ¹ / ₁ / abc ¹ / ₂ : Uppercase alphanumerics abc ¹ / ₁ Sm / abc ¹ / ₂ Sm: Lowercase alphanumerics 123 ¹ / ₁ / 123 ¹ / ₂ : Numbers	[Mode] → Select a character type
2-touch	2 ¹ / ₁ / 2 ¹ / ₂ : Uppercase alphanumerics/Regular kana 2 ¹ / ₁ Sm / 2 ¹ / ₂ Sm: Lowercase alphanumerics/Small kana	<ul style="list-style-type: none">To toggle double-/single-byte: [Mode]To toggle Small kana/Regular kana:
③ Remaining Bytes		

Entering Characters

Example: Enter 鈴木

1 In alphanumerics mode, [Mode] → 漢字

す: three times

ず: * → three times →

き: twice

* When the next character is on the same Key, Press first to move cursor.

2 to enter suggestion list

● To exit list:

3 to select 鈴木

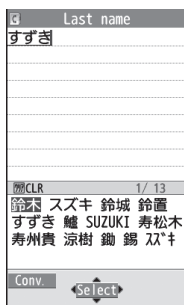
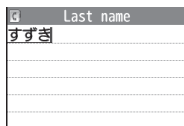

Other Input Functions

Enter katakana/ alphanumerics	[Mode] → Select input mode (character type) → Enter characters
Enter small kana (っ, っ, etc.)	Enter a character → ● Alternatively, Press a Key repeatedly for assigned small kana.
Enter uppercase letters	Enter a character → ● Alternatively, Press a Key repeatedly for assigned uppercase letter.
Add ° or °	Enter a character to add ° or ° → for ° or twice for ° ● In single-byte katakana mode, enter ° or ° as a single-byte character.
Insert line feed	[Line FD] to insert line feeds in text
Add space at end of text	
Insert space within text	repeatedly until single-byte space appears*, or [Menu] → Input Space (Double-byte (single-byte) space is entered in double-byte (single-byte) input mode.)
Reverse toggle	[Rev.] Example: From c, Press to toggle as follows: c → b → a → 2...
Move cursor to beginning/ end of sentence	[Menu] → Jump → To beginning or To end
Undo	[Undo]

*Space cannot be entered in number mode. Use symbol list.

Pictographs/Symbols/Smileys/URLs

- Pictographs do not appear in messages sent to incompatible SoftBank handsets or most e-mail addresses.

- In text entry window,  List log may appear first.

マイ絵¹: My Pictograms
 共通²: Universal (cross-carrier) pictographs
 全絵: All pictographs
 記号: Symbols
 顔文字: Smileys
 URL: URLs

¹ Only in S! Mail text entry window

² Only for S! Mail



- To toggle tabs,  [] or  []
-  to select a pictograph/symbol/smiley/URL
 - To close list: 

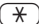

Templates

Insert templates (greetings, URLs, smileys, etc.).

- In text entry window, Press and Hold 
 - Not available in number mode.
- Select a category → Select a template

Additional Features

- In text entry window,  [Menu] → *Templates/Quote*
- Select an item

Item	Operation/Description
Kuten code	Enter a character code > Enter a character code (4 digits)
Quote phone book	Quote Phone Book entry details > Select an entry → Check items →  [Finish]
Quote acct detls	Quote Account Details > Enter Phone Password → Check items →  [Finish]
Bar code reader	Activate Bar Code Reader to insert scanned result

Editing Text

Deleting & Replacing

1 Delete Characters within a Line

Place cursor before a character → 

A character after cursor is deleted.

- Press and Hold  to delete all characters after cursor.

Delete Characters from the End of Text

Place cursor at the end of text → 

A character before cursor is deleted.

- Press and Hold  to delete all characters before cursor.

2 Enter another character

Copy/Cut & Paste

1 In text entry window,  [Menu] → *Copy* or *Cut*

2 Select Text to Copy/Cut

Place cursor before (or after) text to select →  [Start] →

Place cursor after (or before) text →  [End]

Select All (In S! Mail Message Text Entry Window Only)

 [All] → 

3 Place cursor at target location →  [Menu] → *Paste*

Calling

Emergency Calls

Call 110 (Police), 119 (Fire & Ambulance) or 118 (Coast Guard) even when some handset restrictions are active.

- Calls cannot be made in PIN/PIN2, PUK/PUK2 entry window.



Emergency Location Report

When an emergency call is made from handset, location is reported to first response agencies such as the police.

- Location information may be inaccurate due to location or signal conditions. Describe location or nearby landmarks.
- Base Station Positioning System is accurate within 100 meters to 10 kilometers. Location information from distant base stations may be inaccurate.
- Function available wherever system is installed by first response agencies.
- Dialing 184 before 110, 119 or 118, cancels location report. However, first responders may obtain location information for immediate and serious threats to life.
- Not available for international roaming.
- Requires no separate subscription or transmission fees.



Voice Calls

Making Voice Calls

- 1 Enter number with area code → 
 - To adjust Volume: 

- 2  to end call

Call from Call Logs

>  → Select a record → 

Make Calls from Phone Book

>  →  to select a tab → Select an entry →  → Select a number



Show/Hide Caller ID

> Enter number →  [Menu] → **Notify caller ID** → **OFF** or **ON**

- To always show/hide Caller ID: **Main Menu** ► **Settings** ► **Call Settings** ► **Caller ID** ► **Activate** ► **ON, OFF** or **Network Set***

* **Network Set** Caller ID setting varies by subscription.

Answering Voice Calls

- 1 When a call is received,  to talk
 - To adjust Volume: 

- 2  to end call

Video Calls

Video Call Window

Example:

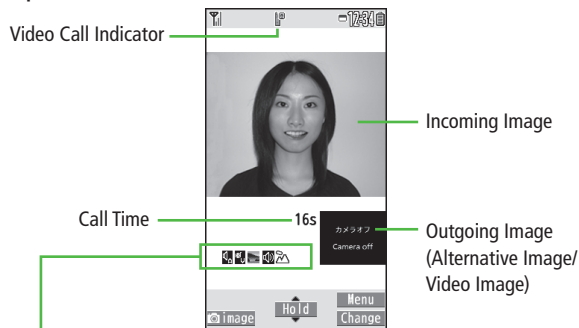

Indicators

- | | |
|------------------------------|------------------------------------|
| : Incoming/Outgoing Sound OK | : Alternative Image ON |
| : Incoming/Outgoing Sound NA | : Speaker ON |
| : Incoming/Outgoing Image OK | : During Bluetooth® handsfree call |
| : Incoming/Outgoing Image NA | : Close-up |
| : Video ON | : Landscape |
| | : Night mode |

● Display appearance may vary by settings/conditions.

Making Video Calls

- 1 Enter number with area code → [V.Call]

Alternative Image is sent.

- To send Video Image: [image]
- To adjust Volume:

- 2 to end call

Call from Call Logs

> → Select a record → [V.Call]

Make Calls from Phone Book

> → to select a tab → Select an entry → → Highlight a number → [V.Call]

Answering Video Calls

- 1 When a video call is received, to talk

- To send Video Image: [image]
- To adjust Volume:

- 2 to end call

International Calls

Calling Abroad from Japan

- No application required. See SoftBank Mobile Website: http://mb.softbank.jp/en/global_services/call/

1 Enter number

2  [Menu] → *Int'l dial assist*

Country/region code list appears.

3 Select a country/region

4 **Voice Call**



Video Call

 [V. Call]

■ Enter Country/Region Code Directly

>  → Press and Hold  for + (IDD Prefix) → Enter a country/region code
→ Enter number (omit first 0) → Voice Call: /Video Call:  [V. Call]

- Do not omit leading 0 when calling Italy (country code: 39).

Global Roaming

- May require Global Roaming Service application. See SoftBank Mobile Website: http://mb.softbank.jp/en/global_services/global_roaming/

Example: When Roaming Dial Assistant is ON

- Roaming Dial Assistant ( P.3-4) is **ON** and **Japan** by default.

1 **Voice Call**

Enter number → 

Video Call

Enter number →  [V. Call]

2 Select an item

Item	Operation/Description
Call to Japan*	Call Japan
Call to set code*	Call a country/region set for Roaming Dial Assistant
As is Call	Manually enter number to call Select when calling within the country/region

*First 0 is replaced by IDD Prefix and country/region code (e.g. +81). (When calling Italy, +39 is added before first 0.)

- Confirmation window appears the first time. Select **NO** to set Roaming Dial Assistant to **OFF**.

Note

- IDD Prefix and country/region code can be manually entered in Step 1.
Alternatively, save IDD Prefix and country/region code in Phone Book entries.

International Call Settings

From ► **Main Menu ► Settings ► International Call**

International Dial Assist Settings

> **Int'l Dial Assist** → Select an item

Item	Operation/Description
Roaming Dial Assistant	Automatically inserts prefixes (IDD Prefix and country code) > ON or OFF (→ For ON , select a country/region)
Country/Area Code	Save country/region codes > Highlight <Not Recorded> → [Edit] → Enter country/region name → Enter country/region code ● To view an entry: Select a saved country/region ● To delete: Highlight a country/region → [Menu] → Delete this or Delete all (→ For Delete all , enter Phone Password) → YES
IDD prefix setting	Edit IDD Prefix. IDD Prefix is set to 0046010 by default > [Menu] → Edit → Edit IDD Prefix

Network Mode

<Default> Automatic

> **Select Network** → Select an item

Item	Operation/Description
Automatic	Handset automatically selects 3G network in Japan, and available network (3G or GSM) abroad
Manual	> Select an item · 3G/GSM : 3G service area in Japan or 3G/GSM abroad. Handset selects an available network automatically. · 3G : 3G service areas in Japan or abroad. · GSM : GSM service areas abroad. Unavailable in Japan.

● **Automatic** is recommended.

Select Operator

<Default> Auto

> **Select Operator** → Select an item

Item	Operation/Description
Auto	Select an operator automatically
Manual	Select an operator manually > Select an operator ● Operators with X are not available. ● To view operator list: [Update]
Network Re-search	Search for available networks ● When Auto , handset selects an available operator automatically. When Manual , operator list appears.

Answer Phone

- When Answer Phone is active, - (Voice Call) or - (Video Call) appears in Standby (Voice Call icon takes priority).
- Unavailable when: handset is off or in Offline Mode; OUT appears. Use Voicemail (P.3-7).

Activating/Canceling Answer Phone

<Default> OFF

- 1 Press and Hold
 - To toggle setting, repeat operation.

■ Redirect a Call to Answer Phone

> [Ans. Ph]

Note

- When limit is reached, new messages cannot be recorded even if Answer Phone is active. Delete old messages (Right).

Playing Messages

When a new message is recorded,
Information Window opens in Standby.

- 1 In Information Window,
Have Answer Ph Msg
- 2 Select a message

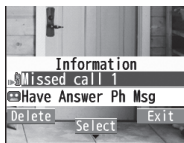

Deleting Messages

Main Menu ► Tools ► Sound Recorders ► Voice Call Data or Video Call Data

- 1 (Highlight a message →) [Menu] → Select an item
- 2 *YES*

■ Delete a message during playback

> During playback, [Erase] → *YES*

Optional Services

- For details, see SoftBank Mobile Website: <http://mb.softbank.jp/en/>

Call Forwarding

Forward unanswerable calls to a preset number when handset is off, out-of-range, etc.

- Call Forwarding and Voicemail cannot be active simultaneously.

Activating Call Forwarding

Main Menu ► Settings ► Call Settings ► Voicemail/Call Fwding

1 **Call Forwarding ON** → Select a type → Enter destination number

-  to select a number from Phone Book.

2 Select an item

Item	Operation/Description
Ringer ON	Forward missed calls > Select a ring time → YES
Ringer OFF	Forward all calls without ringing/vibrating > YES

■ Check Call Forwarding Status

> In Step 1, **Get Status**

■ Cancel Call Forwarding

> In Step 1, **Deactivate All** → **YES**

Note

- Toll free/international numbers cannot be saved as forwarding number.

Voicemail

Unanswered calls are forwarded to Voicemail Center as set or when handset is off, out-of-range, engaged, etc.

- Call Forwarding and Voicemail cannot be active simultaneously.
- Voicemail is not available for Video Calls.

Activating Voicemail

Main Menu ► Settings ► Call Settings ► Voicemail/Call Fwding

1 **Voicemail ON**

2 Select an item

Item	Operation/Description
Ringer ON	Forward missed calls > Select a ring time → YES
Ringer OFF	Forward all calls without ringing/vibrating > YES

■ Check Voicemail Status

> In Step 1, **Get Status**

■ Cancel Voicemail

> In Step 1, **Deactivate All** → **YES**

Playing Voicemail Messages

Information Window and  appear in Standby when new messages are recorded.

1 In Information Window, **Voicemail** → **YES**

Follow voice guidance.

- When Information Window does not appear,
Main Menu ► Settings ► Call Settings
► Voicemail/Call Fwding
► Play Voicemail ► **YES**.

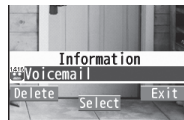

■ View Details

View callers' numbers and date/time of messages before playback.

- Activate Missed Call Notification beforehand (☞ Below).

>  → **Voice Mail Notif.** →  [**91416**]

Missed Call Notification

When Missed Call Notification function is active, Information Window appears for calls missed while handset was off, out-of-range, engaged etc.

- Available only when Voicemail is active.

Main Menu ► Settings ► Call Settings ► Missed Call Notifi.

1 **YES**

Follow voice guidance.

Call Waiting

Place the current call on hold and answer a second, or alternate between calls.

- Separate subscription is required for this service.

Activating/Canceling Call Waiting

Main Menu ► Settings ► Call Settings ► Call Waiting

1 *Activate* or *Deactivate* → YES

■ Check Call Waiting Status

> In Step 1, *Get Status*

Answering Second Call

1 When tone sounds,

- Press  to alternate between calls.
- When a second call comes in while first call is on hold, hold status is canceled and first call resumes.

■ Reject Second Call

> When tone sounds,  [Menu] → *Call Rejection*

Note

- When Voicemail or Call Forwarding is set to **Ringer ON** while Call Waiting is active, unanswered calls are transferred to Voicemail Center or the forwarding number.
- When Voicemail or Call Forwarding is set to **Ringer OFF**, Call Waiting is disabled.

Call Barring

Restrict incoming/outgoing Voice Calls, Video Calls or SMS messages.

- **Bar All Outgoing** and **Bar All Incoming** are not available when Call Forwarding or Voicemail is active. (Call Forwarding or Voicemail takes priority.)
- Emergency numbers (110, 119, 118) are dialable even while Call Barring for outgoing calls is active.

Activating/Canceling Call Barring

Main Menu ► Settings ► Call Settings ► Call Barring

1 Select an item

Item	Operation/Description
Bar All Outgoing	Restrict all non-emergency calls
Bar All Int'l	Restrict all international calls
Bar Int'l	Restrict all international calls except to Japan
Bar All Incoming	Reject all calls
Bar All Roaming	Reject calls when outside Japan

2 *Activate* or *Deactivate* → YES → Enter Center Access Code (Security Code)

■ Check Call Barring Status

> After Step 1, *Get Status*

■ Cancel All Call Barring

> In Step 1, **Cancel All Barring** → Enter Center Access Code (Security Code)



Phone Book

Saving to Phone Book

Creating New Entries

- 1 Press and Hold  → Enter Last name → Enter First name → Select an item → Enter information →  [Finish]

Saving Numbers from Call Logs

- 1  → Highlight a record →  [Menu] → *Add to Phone Book*

- 2 **New Entry**
New → Enter other details

Add to Existing Entry

Add → Select an entry → Enter other details

- When saving to USIM Card, *Overwrite* appears instead of *Add*.

- 3  [Finish] (→ *YES*)

Note

- Press  [Menu] from any function; information is savable if *Add to Phone Book* appears.

From message window, *Add Address*

From photo list/photos, *Set display* → *Phone Book*

Changing Save Settings

Main Menu ► Phone ► Settings ► Save Settings

- 1 *Phone, USIM* or *Ask Every Time*

Managing Phone Book

Editing Phone Book Entries

- 1  → Select an entry →  [Edit] → Edit entry →  [Finish] → *YES*

Delete Phone Book Entries

- >  → Highlight an entry →  [Menu] → *Delete phone book* → Select an item → Follow steps for selected item

Phone Book Memory Status

Main Menu ► Phone ► Memory Status

Messaging

Basics

Send messages via S! Mail, SMS or PC Mail.

- SoftBank Mobile messaging services are available in Japan and overseas.
- For more information, see SoftBank Mobile Website: <http://mb.softbank.jp/en/>

Messaging Folders

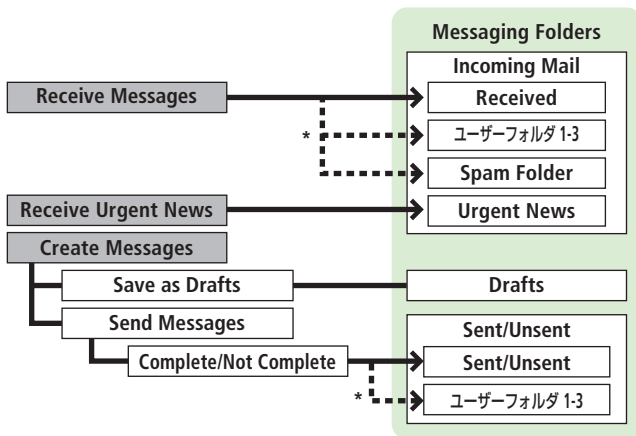

* Set Auto-sort messages to specified folders automatically (☞ P.4-5).

Operations while Using PC Mail

Setting PC Mail accounts creates account folders in Messaging Folders. S! Mail/SMS operations may change as a result.

Auto Resend

Handset saves unsendable messages (out-of-range, Offline Mode) to Unsent folder and automatically sends when able. Messages are protected until sent.

- To selectively cancel Auto Resend: ☑ → **Sent/Unsent** → Select a folder → Highlight a message → ☑[Menu] → **Release Resending**
- Unsendable messages created while Auto Resend is set to **OFF** are not automatically resent. Those already saved before Auto Resend is set to **OFF** are automatically resent. To cancel Auto Resend function, ☑ → **Settings** → **Universal Settings** → **Auto Resend** → **OFF**.

Deleting Messages Automatically

When Messaging Folders are full, old messages are automatically deleted one by one. Protect important messages or set deletion setting to **OFF**. Messages in Drafts and SMS on USIM Card are not deleted automatically.

- To protect messages: In message list, select/highlight a message → ☑[Menu] → **Protect** → **This one** or **Selected** (→ For **Selected**, check messages → ☑[Finish])
- To cancel Auto Delete: ☑ → **Settings** → **Universal Settings** → **Auto Delete** → **Auto Sent Msg Del** or **Auto Received Msg Del** → **OFF**

View Memory Status

> ☑ → **Memory Status**

Messaging Folder Contents

Received/Sent Date & Time,
Sender/Recipient,
Subject/SMS Message Text

Received		1/1
1	 7/ 7 Aoki Taro Hello	
2	 7/ 7 Shirato Hanako Tomorrow	
3	 7/ 7 Aoki Taro Hi	
4	 7/ 7 Keitai Taro Happy	

Example: Received Folder
in Incoming Mail

Message Type/Status

Message Type	Message Status
/ Unread/Read S! Mail	Attachment(s)
/ Unread/Read S! Mail Notice	(Silver) Protected
/ Unread/Read SMS	Forwarded Message
/ Unread/Read USIM Card SMS	Replied Message
/ Unread/Read Urgent News (Emergency earthquake warning)	Failed (Sent/Unsent Message)
/ Unread/Read Urgent News (Disaster and evacuation information)	Resend Scheduled
Forwarded Server Mail	New Delivery Report (Sent/Unsent Message)
/ Unread/Read PC Mail	High Priority
/ Unread/Read PC Mail Notice	Low Priority

Customizing Handset Address

Change your handset mail address (alphanumerics before @) to reduce the risk of receiving spam. Default account name is random alphanumerics.

abc123-xyz @ softbank.ne.jp

[Account] [Domain]
Name Name

(Customize here)

• For details, see SoftBank Mobile Website: <http://mb.softbank.jp/en/>

1 → **Settings** → **Custom Mail Address**

Follow onscreen instructions.

Sending S! Mail & SMS

Sending S! Mail

- 1 Press and Hold 
- 2 Select Address field
- 3 **Select from Phone Book**
Phone Book →
 Select a Phone Book entry →
 Select a mail address or SoftBank handset number

Enter Directly
Enter Mail Address or **Enter Phone Number** →
 Enter mail address or SoftBank handset number

Select from Sent/Received Logs
Sent Address or **Received Address** → Select a record →
 ●[Select]
- 4 Select Subject field → Enter subject
- 5 Select Text field → Enter text
- 6 [Send]

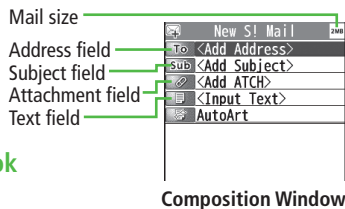

Add Address

- > Select Address field → **<Not entered>** → Search/enter address → Select an address/SoftBank handset number or enter directly → [Finish]

Use Templates

- > In Composition window, [Menu] → **Load Template** → Highlight a template (→ [View]) → ●[Select]

Manual Mail Conversion

- > In Composition window, [Menu] → **Change mail type** → Select an item

Adding Attachments

From ► Composition window, select Attachment field

Add Attachments

- > Select a folder in Data Folder → Select a file

Capture Pictures/Videos to Attach

- > **Activate Camera** → **Camera** or **Video mode** → Frame subject →
 ●[Record] or ○ (→ For video, ●[Stop] or ○) → ●[Save] or ○

Sending SMS Messages

1 → **Create New SMS**

2 Select Address field

3 **Select from Phone Book**

Phone Book →

Select a Phone Book entry →

Select a SoftBank handset number

Enter Directly

Direct Entry → Enter SoftBank handset number

Select from Sent/Received Logs

Sent Address or **Received Address** → Select a record →

 [Select]

4 Select Text field → Enter text

- When number of entered characters exceeds limit, S! Mail conversion option message appears.

5 [Send]

Manual Mail Conversion

> In Composition window,  [Menu] → **Change mail type** → Select an item

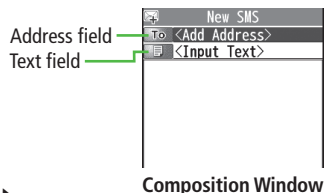

Receiving Messages

Retrieving S! Mail Automatically

Auto download retrieves up to 1 MB messages. Transmission fees are incurred; adjust as required. (To cancel auto download/limit message size for auto download:  P.4-5)

When a new message is received,  appears and Information Window opens in Standby.



1 In Information Window, **New message**

- When Information Window does not appear,  → **Incoming Mail** → Select a folder → Select a message.



Retrieving Complete S! Mail

When Center sends initial portion of message (S! Mail Notice), retrieve the complete message manually.

- 1 Select a message with  or  → Select **continue (xxxKB)** at the end of message text





Incoming Options (S! Mail Only)

From ► **Main Menu** ► **Messaging** ► **Settings** ► **S! Mail Settings** ► **Incoming Options**

- 1 Select an item

Item	Operation/Description
Download Size Limit	Limit maximum incoming message size ➢ 300KB or 2MB
Auto Retrieve Size	Cancel/limit Auto retrieval ➢ Select an item
Auto Retrieve for	Limit Auto retrieval by message type ➢ All Messages or Selected Messages (→ For Selected Messages , Check Address Stored in PB or SoftBank Domain Only →  [Finish])

Setting Filters (Auto-sort)

- 1  → **Incoming Mail** or **Sent/Unsent**
- 2 Highlight a folder →  [Menu] → **Auto-sort Setting**
- 3  [Menu] → Select an item

Item	Operation/Description
Add Subject	Filter messages by subject ➢ Enter a subject ● SMS cannot be sorted by subject.
Add Address	Filter messages by address ➢ Search/enter address → Select/enter an address/SoftBank handset number
Add Group	Filter messages by Group in Phone Book ➢ Select a group
Add Mail group	Filter messages by Mail Group ➢ Select a group

Edit Sort Conditions

➢ After Step 2, highlight an item →  [Edit] → Edit

Delete Auto-sort Settings

➢ After Step 2, (highlight an item →)  [Menu] → **Delete** or **Delete All** (→ For **Delete All**, enter Phone Password) → **YES**

Re-sort Set Folders

➢ To re-sort messages in a specific folder: After Step 1, highlight a folder →  [Menu] → **Re-sort in This** → **YES**

➢ To re-sort messages in all folders: After Step 1,  [Menu] → **Sort in All** → **YES**

PC Mail

- Auto Check settings may incur high packet transmission fees. Be careful, especially when using handset abroad. (To disable Auto Check: Right)

PC Mail Account Setup

- Check ISP information in advance.
- PC Mail services may not be available depending on services, settings, contract details for PC mail account.

1 → **Settings** → **PC Mail Settings** → **Account Settings**

2 **<Not Recorded>** → Select an item

Item	Operation/Description
Account Name	> Enter an account name
Incoming Options	> Select an item → Enter/select an item → Quick ● User Name , Password and Receiving Server are required.
Sending Options	> Select an item → Enter/select an item → Quick ● Mail Address and Sender Server are required.

3 [Finish] → **OK**

Quick Yahoo! Mail Address Setup

- > After Step 1, **Set Quick Yahoo! Mail** → **YES** or **NO**
- Follow onscreen instructions.

Set Default Account

- > After Step 1, highlight an account → [Menu] → **Default account**
- ★ appears for selected account.

Delete Account

- > After Step 1, highlight an account → [Menu] → **Delete account** → Enter Phone Password → **YES**

Sending PC Mail

1 Press and Hold → **PC Mail**

2 Compose a message and send
(From Step 2 on P.4-3)

PC Mail Composition Window

Change Account

- > After Step 1, select Account field → Select an account

PC Mail Settings

From ► **Main Menu** ► **Messaging** ► **Settings**
► **PC Mail Settings** ► **Auto Check**

Auto Check for New Messages

- > **Mail Account** → Select an account (● to toggle on/off) → [Finish]

Set Auto Check Interval/Condition

- > **Interval** → Select an item

Auto Check (while Abroad)

- > **Roaming** → **ON** or **OFF**

Internet

Getting Started

"Yahoo! Keitai" is both a SoftBank Mobile Internet service and the SoftBank Mobile Internet portal.

View PC Internet webpages via PC Site Browser.

Internet

Yahoo! Keitai

- View Mobile Internet webpages
- Download image/sound files, etc.

PC Site Browser

- View PC sites
- Download images

- Separate subscription is required for Network access.
- For more information, see SoftBank Mobile Website: <http://mb.softbank.jp/en/>

SSL/TLS

SSL (Secure Sockets Layer) and TLS (Transport Layer Security) are protocols for safe transmission of important/private information such as credit card numbers.

- Server certificates are saved on handset (☞ P.5-4).

Notes

When a security notice appears, subscribers must decide for themselves whether or not to open the webpage. SOFTBANK MOBILE Corp., VeriSign Japan K.K., Cybertrust Japan Co., Ltd., Entrust Japan Co., Ltd., GMO GlobalSign K.K., RSA Security Inc., SECOM Trust Systems Co., Ltd., Comodo Certificate Authority and Go Daddy, Inc. cannot be held liable for any damages associated with the use of SSL and TLS.

Accessing Internet

Yahoo! Keitai

From ► Main Menu ► Yahoo!

Opening Yahoo! Keitai Menu

- 1 **Open Top Menu**
Yahoo! Keitai

Open Menu List Menu List

- 2 Select a menu item
 - Repeat Step 2 as required.

Web Search

- 1 **Web Search** → Enter text →  [OK]

Entering URL

- 1 **Enter URL**
- 2 **Enter URL Directly**
Direct Entry → Enter URL

Use URL History

URL History List → Select a URL record

Delete URL History Records

> After Step 1, *URL History List* → (Highlight a URL →)  [Menu] → *Delete* or *Delete All* → YES

Using Access History

- 1 **History**
- 2 Select a history record

Delete Access History Records

> After Step 1, (highlight a record →)  [Menu] → *Delete* or *Delete All* → YES (→ For *Delete All*, enter Phone Password)

View Access History URLs

> After Step 1, highlight a record →  [Menu] → *Display URL*

Exiting Mobile Internet

- 1  → YES

Browsing PC Sites

- Some webpages may not be viewable.
- Viewing PC webpages via PC Site Browser may incur high charges.

From ► **Main Menu** ► **Yahoo!** ► **PC Site Browser**

Opening Menu

- 1 *Homepage*
- 2 Select a menu item
 - Repeat Step 2 as required.

Web Search

Follow Step 1 of "Web Search" for Yahoo! Keitai (☞ P.5-2).

Entering URL

Follow Steps 1 & 2 of "Entering URL" for Yahoo! Keitai (☞ P.5-2).

Using Access History

Follow Steps 1 & 2 of "Using Access History" for Yahoo! Keitai (☞ P.5-2).

Exiting Internet

- 1  → *YES*

Bookmarks & Saved Pages

Bookmarks	Save links to webpages. Handset connects to the Network to open the link.
Saved Pages	Save page content. Handset opens saved webpages without connecting to the Network.

Saving Webpages

- 1 Open a webpage →  [Menu] → *Bookmarks* or *Saved Pages* → *Add*
- 2 Select Title field → Edit title
- 3 *OK* → *OK*

Viewing Bookmarks & Saved Pages

Main Menu ► **Yahoo!** (► **PC Site Browser**)

- 1 *Bookmarks* or *Saved Pages* → Select an item

Internet Settings

Web Browsers, Memory Manager & Security

Yahoo! Keitai

From ► **Main Menu** ► **Yahoo!** ► **Set Yahoo! Keitai**

PC Site Browser

From ► **Main Menu** ► **Yahoo!** ► **PC Site Browser**
► **Set PC Site Browser**

■ Font Size

> **Font Size** → Select a size

■ Clear Cache

> **Memory Manager** → **Clear Cache** → **YES**

■ Delete Cookies

> **Memory Manager** → **Delete Cookies** → **YES**

■ Delete User ID or Password Entered when Authentication is Required

> **Memory Manager** → **Delete Certificates** → **YES**

■ Data Storage Location (Yahoo! Keitai Browser only)

> **Save Settings** → **Phone** or **microSD**

■ Auto Send Manufacturer's Number (for Authentication)

> **Security** → **Manufacture Number** → **ON** or **OFF**

■ Referrer Information

> **Security** → **Send Referrer** → **ON** or **OFF**

■ Cookie Storage

> **Security** → **Cookies** → Select an item

■ View Server Certificates Issued by Certificate Authorities

> **Security** → **Root Certificates** → Select an item

■ Authentication Information

> **Security** → **Certificate Retention** → Select an item

Reset

From ► **Main Menu** ► **Yahoo!** (► **PC Site Browser**) ► **Reset**

■ Reset Browser Settings

> **Restore Defaults** → **YES** → Enter Phone Password

■ Initialize Browser

> **Initialize Browser** → **YES** → Enter Phone Password

Connectivity

Infrared

Transfer Phone Book/Schedule entries, messages, Bookmarks and Data Folder files wirelessly between handset and compatible devices, including PCs and other mobiles.

- Align Infrared Ports within 20 cm of one another. Do not move the devices until transfer is complete.

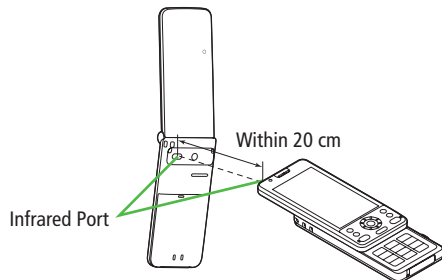

Note

- Following files cannot transfer:
 - Files prohibited for transfers from 103P
 - Phone Book entries and SMS on USIM Card
- If memory becomes full, remaining entries are truncated.

Sending

One/Multiple File Transfer

- 1 Open/highlight a file, and follow steps below:

Files to Send	Operation/Description
Phone Book	> [Y] [Menu] → <i>Send Ir data</i> → <i>Send phonebook</i>
Account Details	> [Ir]
Messages	> [Y] [Menu] → <i>Send Ir data</i> → <i>Send This</i>
Bookmarks	> [Y] [Menu] → <i>Send to ExtnlDvcs</i> → <i>Send Ir data</i> → <i>Send This</i>
Photos/Videos/Widgets	> [Y] [Menu] → <i>Send Ir data</i> <ul style="list-style-type: none">● To send multiple files: [Y] [Menu] → <i>Multiple-choice</i> → Check files to send → [Y] [Menu] → <i>Send Ir data</i>
Other Files	> [Y] [Menu] → <i>Send Ir data</i>

- 2 YES

All File Transfer

Precaution

- Receiving all files overwrites all saved files including secret/protected files.
- Sending all Phone Book entries transfers Account Details as well. User-saved Account Details is overwritten on receiving handset (handset number remains).

Session Number

Session number (4 digits) is required for all file transfers via Infrared. Sender and recipient must enter same Session number to complete transfers.

- 1 In list,  [Menu] → follow steps below:

Files to Send	Operation/Description
Phone Book	<i>Send Ir data → Send all phonebook</i>
Messages	<i>Send Ir data → Send All</i>
Bookmarks	<i>Send to ExtnIDvcs → Send Ir data → Send All</i>
Other Files	<i>Send all Ir data</i>

- 2 Enter Phone Password → Enter Session number → **YES**

Receiving

Main Menu ► Tools ► Receive via Infrared

1 One/Multiple File Transfer

Receive → When a file is received, **YES**

All File Transfers

Receive All → Enter Phone Password → Enter same Session number as sender's → **YES** → **YES**

Bluetooth®

- For details about headset/handsfree devices, see the device manuals.
- Bluetooth® and Wi-Fi devices share the same frequency band. Use of both devices in close proximity may cause interference, affecting transmission speed, clarity or connection quality.

Searching & Pairing Devices

Main Menu ► Tools ► Bluetooth ► Search&Paired Device

- YES***
Device search starts and names of found devices appear.
 - To search again: [Search]

* If there are already paired devices in list, select a device → Select a function
- Select a device → **YES** → Enter Phone Password
- Select text entry field → Enter Bluetooth® Passkey
- Select a Bluetooth® function
Handset connects to Bluetooth® device. When complete, [HSP] flashes in blue.
After no Bluetooth® connection is made for a certain time, [HSP] appears in black and Power saving mode starts.
 - While connected, [Blue] appears. While in Standby, [Gray] appears.

Search&Paired Device List

- Device Type**
- Device Name**
When no names are found, Bluetooth® addresses appear.
- Connection Status**
☒ : Connected ☐ : Not connected
☒ : Not found ☐ : Not paired
- Protection**
Indicator appears when saved contents are protected.
- Profile Status**

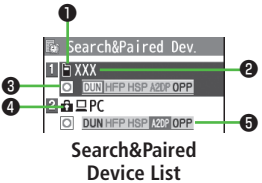

Icon	Letter Color	Background Color	Frame Color	Status
[HSP]	Blue	Gray	—	Not connected (Not paired)
[HSP]	Blue	Gray	Blue	Not connected (Paired)
[HSP]	White	Green	—	Connected
[HSP]	Green	White	Green	Standby for connection
[HSP]	White	Light green	—	Preferred device
[HSP]	Gray	Gray	—	Not supported

Suspending Bluetooth® Functions

Suspend all Bluetooth® functions connected or on standby for connection, and disable Bluetooth®.

Main Menu ► Tools ► Bluetooth

1 Bluetooth OFF → YES

- To return to standby for previously connected function: *Bluetooth ON*

Placing Bluetooth® Devices on Standby for Connection

Main Menu ► Tools ► Bluetooth ► Accept Registered

1 Check functions to be on standby for connection → [Finish]

- To uncheck, select functions to remove check marks.

Sending/Receiving Phone Book

Sending

1 Open Phone Book → [Menu] → *Send to Bluetooth*

2 One File Transfer

Send phonebook → Select a recipient device

All File Transfer

Send all phonebook → Select a recipient device → Enter Phone Password

3 YES

Receiving

Main Menu ► Tools ► Bluetooth ► Receive via Bluetooth

1 One File Transfer

Receive → YES

All File Transfer

Receive All → Enter Phone Password → YES → YES

External Devices

SoftBank Utility Software (Japanese)

Phone Book, Calendar, Tasks, messages, Bookmarks, Notepad and Data Folder files can be transferred to a PC, edited or managed by using SoftBank Utility Software.

- USB Cable (sold separately) is necessary for using SoftBank Utility Software.
- Set USB Mode to **Communication Mode**.
- For SoftBank Utility Software download details, see SoftBank Mobile Website:
<http://www.softbank.jp/mb/r/sbu/> (Japanese)

USB (Japanese)

- Use USB Cable specified by SoftBank Mobile.

Setting USB Mode

<Default> Communication Mode

Main Menu ► Settings ► Connectivity ► USB Mode

1 Select an item

Item	Operation/Description
Communication Mode	Packet transmission, 64K data transmission, data transfer and calls with USB handsfree compatible devices are available
microSD Mode	Read/write data on microSD Card

Data Communication via USB Cable

Use handset as a modem for Internet access by connecting handset with a PC.

- Download utility software from URL below and install on PC.
<http://panasonic.jp/mobile/support/download/103p/index.html>

- 1 Install "USBドライバ (USB Driver)" and "Modem Wizard" from Utility Software (103P) to a PC
- 2 Set handset to **Communication Mode** (☞ Left), and connect handset to PC via USB Cable
 - Power on handset before connecting to PC via USB Cable.
- 3 Start up "103P Modem Wizard," and complete communication setup
 - "Modem Wizard" enables you to set up APN and dial-up easily. For setup/start-up, see "Modem Wizard" Help.

Note

- Connecting handset to a PC or PDA for Internet access may incur high packet transmission fees.

Camera

Before Using Camera

- Notification Lamp illuminates while Camera is active.
- Shutter click sounds at fixed volume even in Manner Mode.

File Formats & Save Location

Photos/videos are saved to Data Folder.

Image Type	File Format	Save Location
Photos	JPEG (.jpg)	Pictures (Data Folder)
Videos	MPEG-4 (.3gp, .mp4), ASF (.asf)	Videos (Data Folder)

Changing Save Location

From ► **Main Menu** ► Camera ► Camera or Video Camera

- 1  [Menu] → *Storage setting* → *Store in*
- 2 *Phone* or *microSD*

Camera Display Indicators

● Images shown below are for reference only.

■ Camera

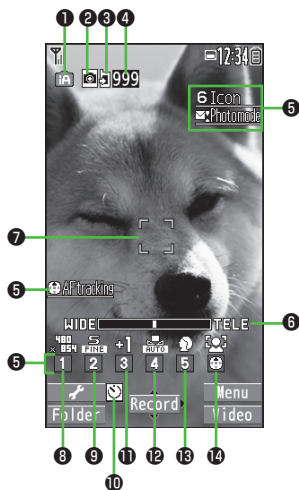

■ Video Camera

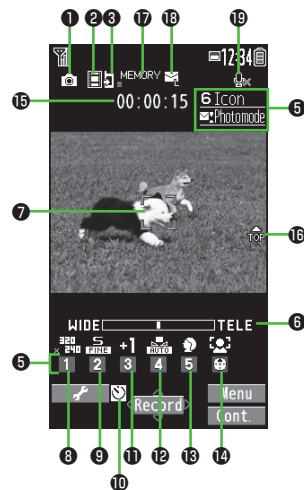

Camera

	Item	Description
1	Photo mode	Intelligent Auto Normal Scene My original setting (For Scene/My original setting, indicators vary by setting.)
2	CHG camera-mode	Camera Video Camera Action mode (Auto/Manual/Auto bracket)
3	Store in	Phone microSD
4	No. of frames	Show number of remaining frames
5	Key guidance	Show Key operation guidance
6	Zoom bar	Indicate zoom level
7	Focus Guide	Auto focus guide AF tracking guide
8	Image size	Indicate image size
9	Quality	Standard Fine Super fine
10	Auto timer	
11	Exposure	Adjust brightness (Level -3 to +3)
12	White balance	Auto Fine Cloudy Light bulb Light
13	Scene	Portrait Sports Food Scenery Nightscape Backlight Character Snow Sunset Pet
14	Focus mode	Face Detection Auto Macro Landscape AF tracking
15	Recordable time	Indicate recordable time
16	Top indicator	Indicate vertical direction
17	Memory capacity bar	Indicate memory status (appears in red when memory is full)
18	File size	Mail restrict'n(S) Mail restrict'n(L) Long time
19	Movie type set	Record video without audio

Key Guidance

- Follow the steps below to change settings:
 - Press Keys indicated by 5 (→ to select an item)
 - to select a setting → to select an item

Taking Photos









- 1  Photo Viewfinder appears.
- 2 Frame subject →  **[Record]** or  Shutter click sounds.
 - To return to Viewfinder without saving the image: 
- 3  **[Save]**
 - To view the photo immediately after capturing:  **[Folder]** →  to return to Viewfinder
- 4  to exit
Return to Standby.







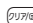





Photo Viewfinder

■ Send Photo via S! Mail

> After Step 2,   → Create message (👉 P.4-3)

Recording Videos

- 1  →  **[Video]**
Video Viewfinder appears.
- 2 Frame subject →  **[Record]** or  to start recording
Tone sounds and ●REC appears.
- 3  **[Stop]** or  to end recording
Tone sounds.
 - To view the video immediately after recording:  **[Play]**
 - To return to Viewfinder without saving the video: 
- 4  **[Save]**
- 5  to exit
Return to Standby.

■ Send Video via S! Mail

> After Step 3,   → Create message (👉 P.4-3)





Video Viewfinder

Camera Functions



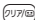

Auto Focus Lock

Bring focus on subject at center of Display automatically.
Lock focus on subject, and recompose your photo.

- 1 In Viewfinder,  or 
 - When in focus, handset sounds. Focus Guide turns green.
 - When out of focus, Focus Guide turns red.
 - To cancel focus: 
- 2 Compose shot
- 3 Capture image in selected Camera mode

AF Tracking

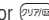
Position AF tracking guide on subject. Camera tracks moving subject, adjusting focus and exposure.

- 1 In Photo Viewfinder, 
AF tracking guide appears.
- 2 Position AF tracking guide on subject and Press 
Upon recognition, AF tracking guide turns yellow and tracking begins.
 - To cancel:  or 
- 3  or  to capture photo

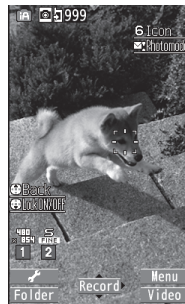

Zoom

- 1 In Viewfinder, 

Auto Timer

1 In Viewfinder, [Menu] → *Auto timer*

2 *ON* → Enter time (seconds)

3 [Record]

Auto timer tone sounds. After set period of time, shutter is released and recording starts.

- While Auto timer is active, Press [Quit] or to return to Viewfinder without canceling Auto timer.

Note

- Auto timer is not available when Action mode is set to *Manual*.
- Auto timer is set to *OFF* after capturing.

Continuous Shooting

Capture a succession of up to 20 still images automatically with a single press.

1 In Photo Viewfinder, [Video] → [Cont.]

appears. (Icon may change depending on modes.)

2 Frame subject → [Record] or

- To stop shooting halfway:

3 **Save All**

[STO all]

Save Selected Images

Select images → [Save]

- Check mark appears on selected images. To cancel selection, select the image again. Check mark disappears.
- To view a full-size Image: Select an image, then Press [Detail] → to return to thumbnail view (to view other images while viewing full-size image.)

Viewing Photos & Videos

Main Menu ► Data Folder

1 **Open Photos**
Pictures

Open Videos
Videos



Example: Pictures

2 Select a folder

3 Select a file

■ Open Photos Saved on microSD Card

> In Step 1, *Pictures* → [microSD] → Select a folder

■ Open Videos Saved on microSD Card

> In Step 1, *Videos* → [microSD] → Select a folder

Other Functions

Digital TV

- Digital TV is available only in Japan.
- USIM Card is required for Digital TV.

Initial Setup

Main Menu ▶ TV ▶ Channel Setting

1 **Select Area** → Select a region → Select a prefecture → **YES**

Automatic Channel Setup

If manual setup fails, try automatic channel setup.

> In Step 1, **Automatic** → **YES** → After channel search, **YES** → Enter title

Using Channel List

From ▶ Main Menu ▶ TV ▶ Channel List

Set Channels

> Select a Channel List

- Select a channel to access the station.

Delete Channel List

> Highlight a Channel List →  [Menu] → **Delete** → **YES**

- Selected Channel List cannot be deleted.







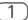

Watching TV

- Set channels beforehand ( Left).

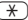
1 

- To switch Portrait/Landscape View: 

2 Select a channel

Direct Channel Access	 - 
	 (Channel 10)
	 (Channel 11)
	 (Channel 12)
Previous/Next Channel	
Channel Search	Press and Hold  ● To stop:  [Cancel] or 

3 To end TV,  → **End TV**

Other Functions

Indicators

- Screenshots provided for reference only.

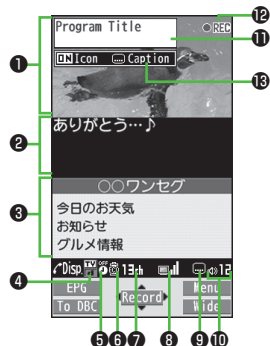
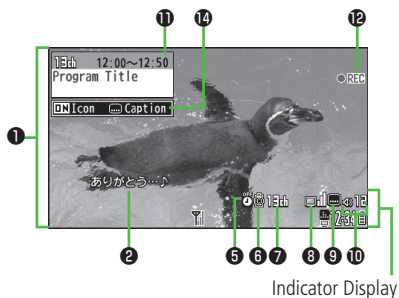

	Item	Description	Operation
1	Image	—	—
2	Captions	—	—
3	Data Broadcast	—	—
4	Data Broadcast Mode	Data Broadcast Mode off Data Broadcast Mode on	[To TV]/[To DBC] ²
5	Off timer	(P.8-3)	—
6	ECO Mode	(P.8-3)	—
7	Channel	(P.8-1) ● When multiple programs are available in the same broadcasting station, "service number/total numbers" appears.	—
8	Signal Strength Level	 Strong ← → Weak Out of range	—
9	Receiving Captions	—	—
10	Volume	—	● Adjust Volume: ¹ ● Mute/Resume: ¹
11	Program Title	—	or ³
12	Recorder Status ¹	Recording Timer Set	(P.8-3)
13	Display/Caption ²	Display: ON/OFF/Large Caption: ON/OFF	 (Each Key press toggles settings.)
14	Indicator/Caption ³	Indicators: ON/OFF Caption: Upper position/Lower position/OFF	 (Each Key press toggles settings.)

¹ Only when Data Broadcast Mode is off ² Only in Portrait View ³ Only in Landscape View

Other Functions

Functions while Viewing TV

From ▶ While TV is active,  [Menu]

■ Set Main/Sub Sound

> *Settings* → *Sound* → *Main/sub sound* → Select an item

■ Set Power Saving Mode

> *Settings* → *ECO Mode* → *YES*

■ Off Timer

> *Settings* → *Off timer* → Select a time or *OFF*

■ View Key Guide

> *Key guide*

Recording/Playing Programs

- Recordings are saved to microSD Card.

Recording Current Program

1 Activate TV (Data Broadcast Mode off) →  [Record]

 appears, and recording starts.

2  [Stop] to end recording

Program is automatically saved.

■ Capture Screenshots

> Activate TV (Data Broadcast Mode off) → Press and Hold 

Playing Recorded Programs

Main Menu ▶ **Data Folder** ▶ **TV** ▶ **Video**

1 Select a video

Playback starts.

2  to stop playback

■ View Captured Screenshots

> **Main Menu** ▶ **Data Folder** ▶ **TV** ▶ **Image** ▶ Select an image

Timer

Main Menu ▶ **TV**

1 *Timer Watching* or *Timer Recording*

2  [New] → Select an item

- Set a channel, date and time to start and end viewing/recording a program.

3  [Finish] → For *Timer Recording*, *YES* or *YES (confirm once)*

Media Player

Play music/video saved on handset/microSD Card.

- Files may not play due to file support issues or microSD Card status, etc.
- When playback starts with low battery, confirmation appears. When Battery is low during playback, confirmation appears.
- Playback pauses for incoming calls or Alarm. Playback resumes after calls are received or Alarm sounds.

Copy Protected Files

Copy protected files may not play, be saved or forwarded. To play a copy protected file, Content Key may be required.
Confirm file expiry date or usage limitations.

Playing Music

Downloading Chaku-Uta Full®

Access webpages directly from Music Player to download Chaku-Uta Full® files.

- View details (price, expiry date, etc.) on source webpage.

Main Menu ► Data Folder ► Music ► Main Folder

1 **Download Music → YES**

Follow onscreen instructions.

Saving Music Files by Using SD Audio

Notes

- Saving music files requires following:
 - 103P
 - microSD Card (commercial item)
 - USB Cable (not included)
 - PC (Windows® XP, Windows Vista®, Windows® 7)
 - Software for PC (commercial item)
 - Panasonic brand "SD-Jukebox" is recommended. Purchase SD-Jukebox from website: <http://club.panasonic.jp/mall/sense/> (Japanese only)
 - Music CD to save

**Main Menu ► Settings ► Connectivity ► USB Mode
► microSD Mode**

- 1 Connect handset to a PC via USB Cable
- 2 Activate SD-Jukebox on PC
- 3 Set a music CD on PC
- 4 Save music files to microSD Card
 - See SD-Jukebox manual for usage information.
 - After saving, release USB Cable from handset.

Playback Window Indicators

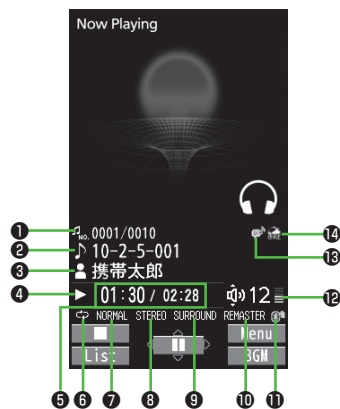

	Item	Description
1	File Number/Total Number	—
2	Title	—
3	Artist	—
4	Status	—
5	Elapsed Time/Total Time	—
6	Play Mode Indicators	Play only one Repeat one Repeat all Random Random play&repeat DEMO
7	Equalizer Setting	Normal H.BASS1 H.BASS2 Train
8	Stereo/Monaural	Stereo Monaural
9	Listening Setting	Surround-sound Natur 1 Natur 2
10	Remaster Setting ON	—
11	Bluetooth® Device	—
12	Volume	—
13	Lyric	—
14	URL	—

Playing Music Files

Main Menu ► Media

1 Music

Player menu appears.

- Last playback window appears.

 [Menu] → **Player menu** to open Music Player menu.

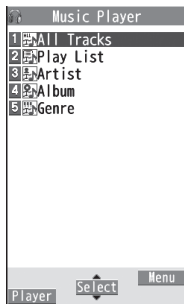



Player menu

2 Select a category















- ★ appears for currently/previously played Play List.

3 Select a file

Selected file plays.

- To end playback:  

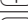
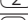
■ Playback Window Operations

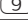
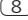
Adjust Volume	
Play Previous*	 <ul style="list-style-type: none"> ● When playback time is over three seconds, previous file plays from beginning.
Play Next*	
Fast-rewind	Press and Hold 
Fast-forward	Press and Hold 
Pause/Resume	  / 
Stop	 
View Next Jacket/Lyric	
View Previous Jacket/Lyric	
Toggle Jacket/Lyric Display	
Toggle Playlist/Playback Window*	 [List/Player]
Play Background*	 [BGM]
Toggle Remaster On/Off	
Toggle Sound Effect (Listening) Modes	
Toggle Equalizer Modes	

* Not available for playback as a demo

Other Functions

Playing Video

Downloading Videos

Access webpages to download video files.

- View details (price, expiry date, etc.) on source webpage.

Main Menu ► Media or Data Folder ► Videos

1 Download Videos → YES

Follow onscreen instructions.





















Playing Video Files

Main Menu ► Media or Data Folder ► Videos

1 Select a folder → Select a file

- To change list view:  [Change]

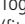
Playback Window Operations

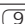
Adjust Volume	
Play Previous	 <ul style="list-style-type: none">● When playback time is over three seconds, previous file plays from beginning.
Play Next	
Fast-rewind	Press and Hold 
Fast-forward	Press and Hold 
Playback Position*	 repeatedly
Change Speed	  /  / 
Mute/Resume	  / 
Pause/Resume	  / 
Play Frame by Frame	While pausing,  [Frame]
Toggle Views	 Toggle: Portrait View → Landscape View (fit to Display size) → Full-size Landscape View*
Toggle Remaster On/Off	
Toggle Sound Effect (Listening) Modes	
Toggle Equalizer Modes	

* May be unavailable depending on image size.

Appendix

Handset Data Backup

Back up Phone Book, Calendar, Tasks, messages, Notepad, and Bookmarks, etc. to microSD Card. Restore files after accidental loss/alteration.

- microSD Card Installation:  P.1-5

Backing up to microSD Card

Main Menu ► Tools ► microSD Backup ► Refer Data

1 Highlight a category →  [Menu] → *Copy to microSD*
(→ For **Bookmarks**, select an item)

2 Enter Phone Password → **YES**

One File Backup

> Open a file →  [Menu] → *Copy to microSD* → **YES**

Restoring from microSD Card

Main Menu ► Tools ► microSD Backup ► Refer Data

1 Select a category

Restore One Item

2 Select a file → Highlight an item →  [Menu] → *Add to phone*

Restore One File

Highlight a file →  [Menu] → *Add to phone* or *Overwrite to phone* → Enter Phone Password

Restore All Files

 [Menu] → *Add all to phone* or *Overwr. all to ph.* → Enter Phone Password

3 YES

Note

- Note that *Overwrite to phone* or *Overwr. all to ph.* erases all files of same category on handset.
- Data backed up in other SoftBank handsets may not be restored in 103P depending on type and size.

All Data Backup/Restoration

Back up/restore handset data (Phone Book, Calendar, messages, Notepad, Bookmarks) all at once.

Main Menu ► Tools ► microSD Backup ► Backup/Restore

1 Select an item → Enter Phone Password → **YES**

Note

- Data backed up in 103P cannot be restored in other handsets.

Software Update

Check for 103P software updates and download as required.

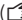
- Transmission fees do not apply to updates (including checking for updates, downloading and rewriting).
- Fully charge Battery beforehand. Even if  appears, low battery message may appear. In this case, charge Battery until Notification Lamp goes out.
- Select a place where signal is strong and stable.
- Other functions are unavailable during update.
- Software Update does not affect Phone Book entries, files saved in Data Folder or other content, but it is recommended that you create a backup of any important information and data (note that some files cannot be copied). SoftBank Mobile is not liable for damages resulting from loss of data, information, etc.
- Do not remove Battery/USIM Card during the update. Update will fail.
- Software Update failure may disable handset. Contact SoftBank Customer Support, Customer Assistance ( P.9-21).

**Main Menu ► Settings ► Phone Settings ► Software Update
► Software Update**

1 [Yes] → Follow onscreen instructions

After download is complete, handset automatically restarts and update begins.

When update is complete,

Software has been successfully updated.

appears. Handset restarts, then Information appears. Entire process takes approximately 60 seconds.

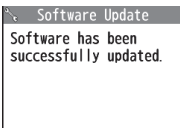

Software Update
Software has been
successfully updated.

Update Results

When Information Window appears,

Software Updt. Result

- When Information Window does not appear,
**Main Menu ► Settings ► Phone Settings
► Software Update ► Update Results**



Scheduled Update

SoftBank Mobile sends update notice via SMS. Read and change preset update schedule as needed. Confirmation appears at scheduled time. Press  or wait a while for update to start.

Note

- If handset does not power on after Software Update, remove then re-insert Battery and try again. If handset still does not power on, contact SoftBank Customer Support, Customer Assistance ( P.9-21).
- SoftBank Mobile is not liable for damages resulting from loss of data, information, etc.
- Alarm tone does not sound during update.
- For more information, see SoftBank Mobile Website: <http://mb.softbank.jp/en/>

Troubleshooting

Handset will not power on

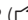
- Was  pressed for more than one second?
- Is battery level sufficient?
- Is Battery installed properly? ( P.1-4)

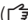

Handset functions do not work after power on

- Does PIN entry window appear?
PIN Authentication ( P.1-13) is **ON**. Enter PIN.



USIM not inserted After power-off Insert USIM or Inserted USIM is unavailable to this mobile phone Please insert valid one appears at power on or after Key press

- Is USIM Card installed correctly? ( P.1-3)
- Is a SoftBank Mobile specified USIM Card installed?
Unusable USIM Card may be inserted.
- USIM Card IC chip may be dirty.
Wipe with a clean cloth, then correctly install USIM Card.

Numeric Keys do not respond

- Does  appear in Standby?
Keyguard ( P.1-8) is active. Cancel it.

Outgoing calls/text messages/Internet transmissions are unavailable

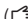
- Does OUT or  appear?
Is handset out-of-range or signal weak?
Move for a stronger signal.
- Does  appear?
Cancel Offline Mode ( P.1-14).
- Are you using handset outside Japan?
Change International Call settings (e.g. Select Operator) ( P.3-4).

Outgoing calls will not connect

- Is area code entered?
- Are outgoing calls restricted (Call Barring)? ( P.3-8)



Call is interrupted or disconnected

- Does OUT appear? Is handset out-of-range or signal weak?
Move for a stronger signal.



Digital TV does not work

- Is handset out of set broadcast area range or TV signal weak?
Confirm Channel List area or move for a stronger signal.

Date & Time is incorrect

- Battery removal does not affect Date & Time, however, a long period without power may. Set Date & Time ( P.1-9) or Retrieve NW Info ( P.1-8).

Cannot charge Battery

- Is AC Charger (sold separately) firmly connected to handset or Desktop Holder (sold separately)? ( P.1-5)
- Is AC Charger securely plugged into AC outlet?
- Is Battery installed in handset correctly? ( P.1-4)
- Is handset correctly mounted in Desktop Holder?
- Are handset, Battery, Desktop Holder and AC Charger terminals clean?
- Battery may not charge beyond +5°C and +35°C.
- Battery may need to be replaced.

Handset/accessories feel warm

- AC Charger/Desktop Holder may become warm during charging.
Handset may become warm during long periods of use. Warmth is considered normal if you can hold it comfortably. Low temperature burns may occur if handset is held against skin for long periods.

Appendix

Battery operating time is greatly reduced



- Battery operating time may be reduced by environmental factors such as temperature, charging conditions or signal strength, as well as by operations or settings. See "Specifications" (📖 P.9-20).

Warning Signs





Problem	Causes and Remedies
OUT appears	Handset is out-of-range. Move to a location where signal is strong.
🔒 appears	Keyguard is active (📖 P.1-8). Cancel Keyguard to use Keys. Answer calls even if Keyguard is active.
Low battery message appears and Battery alarm tone sounds	Battery is low. Charge (📖 P.1-5) or replace Battery (📖 P.1-4).



Safety Precautions

- For proper handset use, read Safety Precautions carefully beforehand.
Keep this guide in a safe place for future reference.
- Safety Precautions contain information meant to prevent injury to the user or others, or property damage, and must be observed at all times.
- SoftBank Mobile is not liable for any damages resulting from use of this product.
- These labels indicate the degree of risk from improper use.
Make sure you thoroughly understand their meanings before reading on.

	Danger	Great risk of death or serious injury from improper use
	Warning	Risk of death or serious injury from improper use
	Caution	Risk of minor injury or damage to property from improper use

- These symbols indicate prohibited or compulsory actions.
Make sure you thoroughly understand their meanings before reading on.

	Prohibited actions
	Disassembly prohibited
	Exposure to liquids prohibited
	Use with wet hands prohibited

	Compulsory actions
	Unplug AC Charger from outlet

Handset, Battery, USIM Card, AC Charger (Sold Separately) & microSD Card (Sold Separately)



Danger



Do not use or leave handset or related hardware in locations subject to high temperatures, such as near an open flame/heater, in sunlight or inside a car on an extremely hot day.

Do not charge, leave, use, or be carrying handset or related hardware in a warm place or where heat collects, such as under a kotatsu (blanketed warming table) or electric blanket, next to a kairo (worn warming patch), etc.

Battery may leak, overheat, explode, or ignite. Handset or related hardware may deform or malfunction. Part of the casing may also become hot and cause burns.



Do not use excessive force to attach Battery or connect AC Charger to handset. Battery or connector may be the wrong way around.

Battery may leak, overheat, explode or ignite.

Appendix



Do not disassemble, modify or solder handset or related hardware.

May cause accidents such as fire, injury, electric shock or equipment malfunction. Battery may leak, overheat, explode or ignite. Modifying handset is a violation of the Radio Law and subject to prosecution.



Do not get handset, Battery and AC Charger wet.

If handset, Battery or AC Charger is left wet or Battery is charged after exposure to liquids such as water or pet urine, overheating, electric shock, fire, injury or malfunction may occur. Be mindful of location when using handset, Battery and AC Charger. Handle with care.



Use specified Battery, AC Charger and Desktop Holder (sold separately).

Battery may leak, overheat, explode or ignite, and AC Charger may overheat, ignite or malfunction.



Warning



Do not place handset, Battery or AC Charger inside cooking appliances, such as microwave ovens or high-pressure containers, or on IH cooking heaters.

Battery may leak, overheat, explode or ignite. Handset or AC Charger may overheat, emit smoke, ignite or malfunction.



Do not drop, throw or otherwise subject to strong force or impact.

Battery may leak, overheat, explode, ignite, or cause electric shock or damage to handset.



Keep liquids (water, pet urine, etc.) or conductive objects (pencil leads, metal parts, necklaces, hair pins, etc.) away from Charger terminals, External Device Port terminals or microSD Card Slot.

May cause fire or malfunction triggered by short-circuit.



Keep handset off and AC Charger disconnected near propane gas, in filling stations or places where flammable gas is generated.

Handset use in such areas may lead to fire.



If handset, Battery or AC Charger emits an unusual sound, smoke or odor, perform following steps:

1. Unplug AC Charger/In-Car Charger.
 2. Power off handset.
 3. Remove Battery. (Take care to avoid burns or injuries.)
- May cause fire or electric shock.



Caution



Do not place handset, Battery or AC Charger on an unstable surface.

May fall, causing injury or malfunction. Take extra precautions while Vibration is active or during charging.



Keep handset and related hardware out of the reach of young children.

May result in accidental ingestion or injury.



If for use by child, guardian should teach proper handling and ensure handset and related hardware is used as directed.

May result in injury.

Battery



Danger

See Battery label to confirm battery type.

Label	Battery Type
Li-ion 00	Lithium-ion



Do not throw Battery into fire.

Battery may leak, explode or ignite.



Do not pierce Battery with a nail or other sharp object, hit it with a hammer, step on it, or subject it to strong shock.

Battery may leak, overheat, explode or ignite.



Do not touch terminals with metallic objects or carry/store Battery with conductive objects (pencil leads, metal parts, necklaces, hair pins, etc.).

Battery may leak, overheat, explode or ignite.



If battery fluid gets into eyes, do not rub. Flush with clean water and see a doctor immediately.

Failure to do so may cause blindness.



Warning



If battery fluid comes into contact with skin or clothing, stop handset use immediately and rinse fluid off with clean water.

Battery fluid is harmful to your skin.



If Battery does not charge after specified time, stop charging.

Battery may leak, overheat, explode or ignite.



If Battery emits an unusual odor, overheats, discolors or deforms, immediately remove it and keep away from fire. Take care to avoid burns or injuries.

Battery may leak, overheat, explode or ignite.



Keep Battery away from pets.

Pet bites may cause Battery to leak, overheat, explode or ignite. Handset may malfunction.



Caution



Do not dispose of Battery with ordinary refuse.

Tape over terminals to insulate Battery. Take it to a SoftBank Shop or institution that handles used batteries in your area. Comply with local waste disposal regulations.

Handset



Warning

**Do not use handset while driving a vehicle.**

Doing so, even with earphone, may interfere with safe driving and cause an accident. Stop your vehicle to park in a safe place before using handset.

Drivers using handsets while driving are subject to prosecution.

**Do not aim Infrared Port at eyes during infrared transmissions.**

Doing so may affect eyes.

**Power off handset near high-precision electronic devices or devices using weak electronic signals.**

Handset may cause these devices to malfunction.

*Electronic devices that may be affected: Hearing aids, implantable cardiac pacemakers, implantable cardioverter defibrillators, other medical electronic devices, fire alarms, automatic doors and other automatically controlled devices.

**Power off handset aboard aircraft.**

Handset signal may interfere with aircraft operation.

When in-flight handset use is permitted, follow airline instructions for proper use.

**If you have a weak heart, take extra precautions when setting functions such as Vibration or Volume for incoming transmissions.**

May affect heart.

**In a thunderstorm, immediately power off handset and seek shelter.**

There is a risk of being struck by lightning and suffering electric shock.



Caution

**If handset affects car electronics, stop use.**

Handset use may affect electronics in some models. In this case, stop use; could impede safe driving.

**Do not place a magnetic card near or in handset.**

The stored magnetic data in cash cards, credit cards, telephone cards and floppy disks, etc. may be erased.

**Do not swing handset by Strap, etc.**

Handset may strike you or others, or Strap may be broken resulting in injury or damage to handset or other property.

**Do not place your ear too close to Speaker while ringer sounds or sound files play.**

May impair hearing.

**Do not use handset when it is damaged.**

May cause fire, injury or electric shock.

Appendix



If skin abnormality occurs, immediately stop use and seek medical treatment.

Handset contains metals. Handset use may cause itching, rashes, eczema or other symptoms depending on the user's physical condition.

Parts		Materials/Surface Finish
Outer Case	Keypad side, Display rear side, Battery side	ABS/UV coating
	Display side, Hinge holder	PC/UV coating
	External Device Port terminals	Stainless steel/ Nickel plating, Gold plating
External Device Port Cover		Elastomer
Camera Panel, Display Panel		PMMA/Hard coating
Protrusions on Camera Panel		ABS
Charging terminals		Phosphor bronze/ Nickel plating, Gold plating
Keypad	Center Key	PC/Hard coating
	Sheet	PC
	Keys	PC/UV coating
Stop pads		Acrylic urethane
Notification Lamp		PC/Evaporated tin, UV coating
Battery Cover	Resin part	ABS/UV coating
	Battery compartment sheet	PC
Battery compartment		PC
Battery terminals	Resin part	PPS
	Terminals	Beryllium copper/ Nickel plating, Gold plating

Parts		Materials/Surface Finish
Battery	Resin part	PC
	Terminals	Glass fiber reinforced epoxy board/ Nickel plating, Gold plating
	Label	PET
Screws (Battery compartment)		Iron/Nickel plating
Nameplate		Polyester
microSD Card	Metal part	Stainless steel/Nickel plating
Slot (Battery compartment)	Resin part	LCP



Handset may become hot while used in a hot environment.

Avoid prolonged skin contact that may result in burns.



Make sure not to trap fingers or objects when opening/closing handset.

May result in injury or damage to Display.



Watch TV with adequate lighting and distance from Display.

May damage eyesight.



Do not turn up Volume unnecessarily high when using earphones.

Using earphones with Volume turned up for an extended period may impair hearing.

AC Charger (Sold Separately)



Warning



Do not cover or wrap AC Charger during charging.

May cause overheating, fire or malfunction.



Always use the specified power supply/voltage.

Using incorrect voltage may cause fire or malfunction.

AC Charger: AC100V-240V (household AC outlet only)

In-Car Charger (sold separately): DC12V, 24V (vehicles with a negative earth only)

Do not use transformer for charging. May cause fire, electric shock or malfunction.



Use In-Car Charger (sold separately) in vehicles with a negative (-) earth. Do not use In-Car Charger if vehicle has a positive (+) earth.

May cause fire.



Do not use AC Charger in thunderstorms.

Risk of electric shock.



Do not handle AC Charger with wet hands.

May cause electric shock or malfunction.



If In-Car Charger (sold separately) fuse blows, always replace it with specified fuse.

Using the incorrect fuse may cause fire or malfunction. Refer to the respective manuals for information on the correct fuse specifications.



If dust accumulates on plug, unplug AC Charger and wipe with a dry cloth.

May cause fire.



When plugging AC Charger into AC outlet, keep conductive materials (pencil leads, metal parts, necklaces, hair pins, etc.) away from Desktop Holder terminals or AC Charger plug/terminals and plug AC Charger firmly into AC outlet.

May cause electric shock, short-circuit or fire.



Unplug AC Charger during periods of disuse.

May cause electric shock, fire or malfunction.



If liquid (water, pet urine, etc.) gets into AC Charger, unplug it immediately.

May cause electric shock, smoke emission or fire.



Caution



Do not subject AC Charger to strong force or impact when connecting to AC outlet.

May cause injury or malfunction.



Pull AC Charger (not cord) to unplug AC Charger.

Pulling on the cord may damage the cord and cause electric shock or fire.



Always unplug AC Charger before cleaning it.

May result in electric shock.

Near Electronic Medical Equipment



Warning

This section is based on "Guidelines on the Use of Radio Communications Equipment such as Cellular Telephones and Safeguards for Electronic Medical Equipment" (Electromagnetic Compatibility Conference, April 1997) and "Report of Investigation of the Effects of Radio Waves on Medical Equipment, etc." (Association of Radio Industries and Businesses, March 2001).



If you use an implantable cardiac pacemaker or cardioverter defibrillator, keep handset more than 22 cm away from the implant at all times.

Handset radio waves may affect implantable cardiac pacemaker or cardioverter defibrillator operation.



Persons using electronic medical equipment outside medical facilities should consult the vendor about possible radio wave effects.

Handset radio waves may affect electronic medical equipment operation.



Observe the following in medical facilities. Handset radio waves may affect electronic medical equipment.

- Do not take handset into operating rooms, Intensive Care Units or Coronary Care Units.
- Power off handset inside hospital wards.
- Power off handset even outside hospital wards (in hospital lobbies, etc.). Electronic medical equipment may be in use nearby.
- Where a medical facility has specific instructions prohibiting the carrying and use of mobile phones, observe those instructions strictly.



Power off handset in crowded places such as rush hour trains. Implantable cardiac pacemakers or cardioverter defibrillators may be in use nearby.

Handset radio waves may affect implantable cardiac pacemaker or cardioverter defibrillator operation.

Handling Precautions

General Notes

- SoftBank Mobile is not liable for damages from loss of handset/microSD Card information (Address Book entries, image/sound files, etc.) due to accidental loss/alteration/repair of handset. Back up important information.
- Handset transmissions may be disrupted inside buildings, tunnels or underground, or when moving into/out of such places.
- Use handset without disturbing others.
- Handsets are radios as stipulated by the Radio Law. Under the Radio Law, handsets must be submitted for inspection upon request.
- Handset use near landlines, TVs or radios may cause interference.
- Read microSD Card manual beforehand for proper use.
- Beware of eavesdropping.
Digital signals reduce interception, however, transmissions may be overheard. Deliberate/accidental interception of communications constitutes eavesdropping.
"eavesdropping" means radio communication is received by another receiver deliberately or accidentally.
- Be cautious of unsafe webpages. Take extra precautions especially when posting personal information on webpages.

Electromagnetic Safety

- For body-worn operation, this mobile phone has been tested and meets RF exposure guidelines when used with an accessory containing no metal and positioning handset a minimum 15 mm from the body. Use of other accessories may not ensure compliance with RF exposure guidelines.

FCC Notice

- This device complies with part 15 of the FCC Rules. Operation is subject to the following two conditions:
(1) This device may not cause harmful interference, and
(2) this device must accept any interference received, including interference that may cause undesired operation.
- Changes or modifications not expressly approved by the manufacturer responsible for compliance could void the user's authority to operate the equipment.

FCC RF Exposure Information

Your handset is a radio transmitter and receiver. It is designed and manufactured not to exceed the emission limits for exposure to radio frequency (RF) energy set by the Federal Communications Commission of the U.S. Government.

The guidelines are based on standards that were developed by independent scientific organization through periodic and thorough evaluation of scientific studies. The standards include a substantial safety margin designed to assure the safety of all persons, regardless of age and health.

The exposure standard for wireless handsets employs a unit of measurement known as the Specific Absorption Rate, or SAR.

The SAR limit set by the FCC is 1.6 W/kg. The tests are performed in positions and locations (e.g. at the ear and worn on the body) as required by the FCC for each model.

The highest SAR value for this model handset as reported to the FCC when tested for use at the ear is 0.638 W/kg, and when worn on the body in a holder or carry case, is 0.306 W/kg.

Body-worn Operation; This device was tested for typical body-worn operations with the back of the handset kept 1.5 cm from the body. To maintain compliance with FCC RF exposure requirements, use accessories that maintain a 1.5 cm separation distance between the user's body and the back of the handset. The use of beltclips, holsters and similar accessories should not contain metallic components in its assembly.

The use of accessories that do not satisfy these requirements may not comply with FCC RF exposure requirements, and should be avoided. The FCC has granted an Equipment Authorization for this model handset with all reported SAR levels evaluated as in compliance with the FCC RF emission guidelines. SAR information on this model handset is on file with the FCC and can be found under the Display Grant section of <http://www.fcc.gov/oet/ea/> after searching on FCC ID UCE211049A.

Additional information on Specific Absorption Rates (SAR) can be found on CTIA-The Wireless Association® (CTIA) website at <http://www.ctia.org/>.

European RF Exposure Information

Your mobile device is a radio transmitter and receiver. It is designed not to exceed the limits for exposure to radio waves recommended by international guidelines. These guidelines were developed by the independent scientific organization ICNIRP and include safety margins designed to assure the protection of all persons, regardless of age and health.

The guidelines use a unit of measurement known as the Specific Absorption Rate, or SAR. The SAR limit for mobile devices is 2 W/kg and the highest SAR value for this device when tested at the ear was 0.803 W/kg*. As mobile devices offer a range of functions, they can be used in other positions, such as on the body as described in this guide**. In this case, the highest tested SAR value is 0.613 W/kg***. As SAR is measured utilizing the devices highest transmitting power the actual SAR of this device while operating is typically below that indicated above. This is due to automatic changes to the power level of the device to ensure it only uses the minimum level required to reach the network.

The World Health Organization has stated that present scientific information does not indicate the need for any special precautions for the use of mobile devices. They note that if you want to reduce your exposure then you can do so by limiting the length of calls or using a hands-free device to keep the mobile phone away from the head and body.

*The tests are carried out in accordance with international guidelines for testing.

**Please see Electromagnetic Safety on page 9-12 for important notes regarding body-worn operation.

***A method of measuring SAR when a mobile phone is used at positions other than at the ear was established in March 2010 through an international standard (IEC62209-2). MIC technical regulation was reported in October 2011 by the Information and Communications Council.

World Health Organization
<http://www.who.int/emf>

List of Specific Absorption Rates (SAR) for radio waves by SoftBank 3G model
<http://mb.softbank.jp/mb/support/3G/product/sar/> (Japanese)

Declaration of Conformity

CE0168

We, Panasonic Mobile Communications Development of Europe Ltd., declare that SoftBank 103P conforms with the essential and other relevant requirements of the directive 1999/5/EC.

A declaration of conformity to this effect can be found at <http://panasonic.net/pmc/support/index.html>

- This product is only intended for sale in Japan.
- Compliance to the European RTTE directive applies to: SoftBank 103P handset, Battery (PMBAS1) and AC Charger (SoftBank ZTDAA1, marked MITSUMI).

Handset Care

- 103P is not waterproof. Avoid exposure to liquids and high humidity.
 - Do not expose handset to precipitation.
 - Air-conditioned air may cause condensation, resulting in corrosion.
 - Do not put handset in damp places like bathrooms.
 - On the beach, keep handset away from sun and surf.
 - Perspiration entering handset may cause malfunction.
- If handset is left with no Battery or an exhausted one, data may be altered/lost. SoftBank Mobile is not liable for any resulting damages.
- Use handset within temperatures of 5°C to 35°C and humidity 35% to 85%. Avoid extreme temperatures/direct sunlight.
- Handset may become warm during use or charging. This is not a malfunction.
- Battery may swell as service life nears end. This is not a problem.

- Exposing lens to direct sunlight may damage color filter and affect image color.
- Soiled terminals may cause poor connection. If terminals are dirty, use a dry cloth or cotton swab to wipe them clean.
- Clean handset with a dry, soft cloth. Using alcohol, thinner, etc. may damage it.
- Avoid forcefully rubbing or scratching Display.
- Do not subject handset to excessive force.
 - Do not sit down with handset in a back pocket.
 - Do not place heavy objects in a bag with handset inside.
- Do not remove nameplate from handset. Doing so invalidates warranty.
- Always power off handset before removing Battery. If Battery is removed while saving or sending mail, data may be altered or lost.
- Display is manufactured with high precision technology, however, some pixels may appear darker/brighter.
- Connect only specified products to External Device Port.
- While walking, moderate earphone volume to make sounds around you audible and help avoid accidents.
- When holding handset in use, do not cover Speaker.

Function Usage Limits

- USIM Card must be installed to use handset.

Multitasking during Calls/Data Transmissions

- Calls/data transmissions incur transmission fees even when other functions/operations are simultaneously in use.

Camera

- Be sure to observe proper etiquette when using Camera.
- Do not expose Camera lens to direct sunlight. Concentrated sunlight through Camera lens may cause handset to malfunction.
- Be sure to try taking and previewing pictures before using Camera on important occasions like wedding ceremonies.
- Do not commercially use or transfer pictures taken with Camera without the permission of the copyright holder (photographer), except for personal use.
- Do not use Camera in locations where taking photos and recording videos are prohibited.

Bluetooth®

- Connection with all Bluetooth® devices is not guaranteed.
- Handset complies with Bluetooth® security standards. However, this does not ensure complete security.
- SoftBank Mobile is not liable for damages from Bluetooth® transmission data leakage.
- Bluetooth® transmits on the same frequency band as microwave ovens or other industrial/scientific/medical equipment, radio stations, amateur radio stations (hereafter "other radio stations"), etc.
 - 1 Before Bluetooth® use, visually confirm that other radio stations using the same frequency band are not nearby.
 - 2 If interference between handset and other radio stations occurs, move handset or immediately cancel Bluetooth® transmission.
 - 3 For more information, contact SoftBank Customer Support, General Information (☎ P.9-21).

Wireless Frequency Bands

- Bluetooth® frequency band:



- 2.4 GHz band with FH-SS modulation; maximum communication distance is 10 m.
- 2400 – 2483.5 MHz band. Avoiding the frequency band of a mobile unit identification apparatus is not possible.
- When using the Bluetooth® function in other countries, check local regulations beforehand.

Copyrights

Portrait Rights

Individuals have the right to refuse being photographed or publication or use of their image. Personality rights, or Right of Publicity, is a form of property right designed to protect celebrity interests that applies to all people. Be careful when using handset Camera. Photographing or distributing the images of others without permission is unlawful.

Copyrights

Sounds, images, computer programs, databases, other copyrighted materials, their respective works and copyright holders are protected by copyright laws. Duplicated materials are limited to private use only. If duplications (including conversion of data types), modifications, transfer of duplicates or distribution on networks are made without permission of copyright holders, it constitutes "Literary Piracy" and "Infringement of Copyright Holder Rights" and a lawsuit for reparations may be filed and may result in criminal punishment. If duplicates are made using handset, please observe the copyright laws. Materials captured with handset Camera are also subject to the above.

- Do not copy, modify, separate from hardware, disassemble, decompile or reverse engineer the whole or part of the software installed in this product without permission of the copyright holder, and do not have any third party do the same, nor utilize any consequences of such deeds.

This product is licensed under the MPEG-4 patent portfolio license, AVC patent portfolio license and VC-1 patent portfolio license for the personal use of a consumer or other uses in which it does not receive remuneration to

- (i) encode video in compliance with the MPEG-4 Visual Standard, AVC Standard and VC-1 Standard ("MPEG-4/AVC/VC-1 Video") and/or
- (ii) decode MPEG-4/AVC/VC-1 Video that was encoded by a consumer engaged in a personal activity and/or was obtained from a video provider licensed to provide MPEG-4/AVC/VC-1 Video.

No license is granted or shall be implied for any other use.

Additional information may be obtained from MPEG LA, L.L.C. See

<http://www.mpegla.com>.

MPEG Layer-3 audio coding technology licensed from Fraunhofer IIS and Thomson.

Microsoft®, Windows® and Windows Vista® are trademarks or registered trademarks of Microsoft Corporation in the United States and other countries.

The abbreviations used for respective operating systems (Japanese version) in this guide are as shown below:

Windows® 7 is the abbreviation of Microsoft® Windows® 7 (Starter, Home Basic, Home Premium, Professional, Enterprise and Ultimate). Windows Vista® is the abbreviation of Windows Vista® (Home Basic, Home Premium, Business, Enterprise, and Ultimate).

Windows® XP is the abbreviation of Microsoft® Windows® XP Professional operating system or Microsoft® Windows® XP Home Edition operating system.

Appendix

Microsoft Windows operating system is abbreviated as "Windows" in this guide.

Java and all Java based trademarks and logos are trademarks or registered trademarks of Oracle and/or its affiliates.



Aplix, microJB Blend and JB Blend, and all Aplix- or JB Blend-related trademarks and logos are trademarks or registered trademarks of Aplix Corporation in the U.S., Japan and other countries.

QR Code is a registered trademark of DENSO WAVE INCORPORATED.



microSDHC Logo is a trademark of SD-3C, LLC.

Chaku-Uta® and Chaku-Uta Full® are registered trademarks of Sony Music Entertainment (Japan) Inc.

Machi-Uta® is a registered trademark of KDDI CORPORATION.

This product contains software licensed complying with GNU General Public License, Version 2 (GPL v2), GNU Lesser General Public License (LGPL), etc.

The program is free software; you can copy it and/or redistribute it and/or modify it under the terms of the GPL v2 or LGPL as published by the Free Software Foundation.

At least three(3) years from delivery of products, Panasonic Mobile Communications Co., Ltd will give to any third party who contact us at the contact information provided below, for a charge no more than our cost of physically performing source code distribution, a complete machine-readable copy of the corresponding source code covered under GPL v2/LGPL.

Contact Information

pmc-cs@gg.jp.panasonic.com

Source code is also freely available to you and any other member of the public via the website below.

<http://panasonic.jp/mobile/gpl-s/english.html>

Please note that we cannot respond to any inquiries regarding the source code.

You cannot download the source code from a mobile phone. Use your PC to download the source code.

For more details on the relevant software (including license information of GPL v2/LGPL), follow these steps: *Main Menu* → *Settings* → *Phone Settings* → *GPL License* etc.



Bluetooth® is a registered trademark of the Bluetooth SIG, Inc.

The Bluetooth word mark and logos are owned by the Bluetooth SIG, Inc. and any use

of such marks by Panasonic Mobile Communications Co., Ltd. is under license.

Other trademarks and trade names are those of their respective owners.

This product is loaded with Bluetooth™ Stack for Embedded Systems Spec 2.0 by Toshiba Corp.

Powered by MascotCapsule®

MascotCapsule® is a registered trademark of HI CORPORATION

© 2012 HI CORPORATION. All Rights Reserved.

NetFront®
Mobile Client Suite

ACCESS™

This product contains NetFront Browser and NetFront Messaging Client software of ACCESS CO., LTD.

Copyright © 2004-2012 ACCESS CO., LTD.

ACCESS and NetFront are trademarks or registered trademarks of ACCESS CO., LTD. in Japan and other countries.

This software is based in part on the work of the Independent JPEG Group.

IrFront is a trademark or registered trademark of ACCESS CO., LTD. in Japan and other countries.

The IrDA Feature Trademark is owned by the Infrared Data Association and used under license therefrom.

"AutoArt" adopted by this product is based on Emoji Lite®, protected by the intellectual property rights of Acrodea, Inc.

SOFTBANK, SOFTBANK's equivalent in Japanese and the SOFTBANK logo are registered trademarks or trademarks of SOFTBANK MOBILE Corp. in Japan and other countries.

COLOR LIFE, S! Mail, Graphic Mail, MOBILE WIDGET and PC Mail are trademarks or registered trademarks of SOFTBANK MOBILE Corp.

Yahoo! and the "Yahoo!" or "Y!" logos are trademarks and/or registered trademarks of Yahoo! Inc. in the U.S.

This product is manufactured or sold under license from InterDigital Technology Corporation.

Other company and product names mentioned herein are trademarks or registered trademarks of their respective owners.

RF Exposure Information/Specific Absorption Rate (SAR) Information

This mobile phone 103P meets the MIC's**** technical regulation for exposure to radio waves.

The technical regulation* established permitted levels of radio frequency energy, based on standards developed by independent scientific organizations through periodic and thorough evaluation of scientific studies.

The regulation employs a unit of measurement known as the Specific Absorption Rate, or SAR.

The SAR limit is 2 watts/kilogram (W/kg)** averaged over ten grams of tissue.

The limit includes a substantial safety margin designed to assure the safety of all persons, regardless of age and health.

The value of the limit is equal to the international guidelines recommended by ICNIRP*****.

The highest SAR value for this mobile phone is 0.889 W/kg when tested for use at the ear.

While there may be differences between the SAR levels of various phones and at various positions, all phones meet MIC's technical regulation.

Although the SAR is determined at the highest certified power level, the actual SAR of the phone during operation can be well below the maximum value.

Use at positions other than at the ear

This mobile phone may be used at positions other than at the ear. By using an accessory such as a belt clip holster that maintains a 1.5 cm separation with no metal (parts) between the body and the mobile phone, this mobile phone will comply with international guidelines for radio wave protection (***).

The World Health Organization has announced that "A large number of studies have been performed over the last two decades to assess whether mobile phones pose a potential health risk. To date, no adverse health effects have been established as being caused by mobile phone use."

For more information about SAR, see the following websites:

Ministry of Internal Affairs and Communications (MIC)
<http://www.tele.soumu.go.jp/e/sys/ele/body/index.htm>

Association of Radio Industries and Businesses (ARIB)
<http://www.arib-emf.org/index02.html> (Japanese)

* The technical regulation is provided in Article 14-2 of the Ministry Ordinance Regulating Radio Equipment.

** Provided for in "Radio-radiation protection guidelines", reported in 1997 by the Telecommunications Technology Council, Ministry of Posts and Telecommunications.

*** A method of measuring SAR when a mobile phone is used at positions other than at the ear was established in March 2010 through an international standard (IEC62209-2). MIC technical regulation was reported in October 2011 by the Information and Communications Council.

**** Ministry of Internal Affairs and Communications

***** International Commission on Non-Ionizing Radiation Protection

Standards of the Federal Communications Commission (FCC) of the U.S. Government and information from the E.U. are given as information relating to RF exposure. For details, see "FCC RF Exposure Information" and "European RF Exposure Information".

Specifications

103P

Weight (including Battery)		110 g*
Dimensions (closed)		50 x 109 x 16.5-18 mm*
Continuous Standby Time	3G	630 hours*
	GSM	360 hours*
Continuous Talk Time	3G	230 minutes*
	Video Call	150 minutes*
	GSM	230 minutes*
TV Reception Time	Normal Mode	5.25 hours*
	ECO Mode	6.5 hours*
Charging Time		130 minutes*
Maximum Output	3G	0.25 W
	GSM	2.0 W

* Approximate value

Battery

Voltage	3.7 V
Battery Type	Lithium-ion
Capacity	800 mAh
Dimensions	45 x 4.5 x 37 mm*

* Approximate value

● Specifications subject to change without notice.

Support

Warranty

Warranty is provided when you purchase a 103P.

- Check name of distributor and date of purchase.
- Read through contents and keep in a safe place.
- Warranty term is described in Warranty.

SoftBank Mobile is not liable for any damage resulting from use of this product.

After-Sales Service

See "Troubleshooting" (🔗 P.9-3) before contacting SoftBank Mobile for service or repairs. If you cannot find solutions or solve problems, contact SoftBank Customer Support, Customer Assistance (🔗 P.9-21) in your subscription area and provide a detailed description of the problem.

- Repairs within Warranty are performed under terms and conditions described.
- Out of Warranty, any repairs are performed upon request at subscriber's expense.

Customer Service

For SoftBank handset or service information, call General Information.
For repairs, call Customer Assistance.

SoftBank Customer Support

General Information	
From a SoftBank handset, dial toll free at	157
From a landline/IP phone, dial toll free at	0800-919-0157

Customer Assistance	
From a SoftBank handset, dial toll free at	113
From a landline/IP phone, dial toll free at	0800-919-0113

SoftBank Mobile Global Call Center

From outside Japan, dial +81-3-5351-3491 (toll free from SoftBank handsets)
If handset is lost/stolen, call this number immediately (international charges apply)

SoftBank 103P User Guide

June 2012, First Edition

SOFTBANK MOBILE Corp.

For additional information, please visit a SoftBank Shop.

Model: SoftBank 103P

Manufacturer: Panasonic Mobile Communications Co., Ltd.



モバイル・リサイクルネットワーク
携帯電話・PHSのリサイクルにご協力を。

Please help the mobile industry maintain high environmental standards. Recycle your old handsets, batteries and charger units (all manufacturers and brands). Before you recycle, please remember these important points:

- Handsets, batteries and chargers submitted for recycling cannot be returned.
- Always erase all data recorded on old handsets (Phone Book entries, call records, mail, etc.) before recycling.